

Note
Filter Fabric is to be
Placed around existing Conc. Pilot Channel

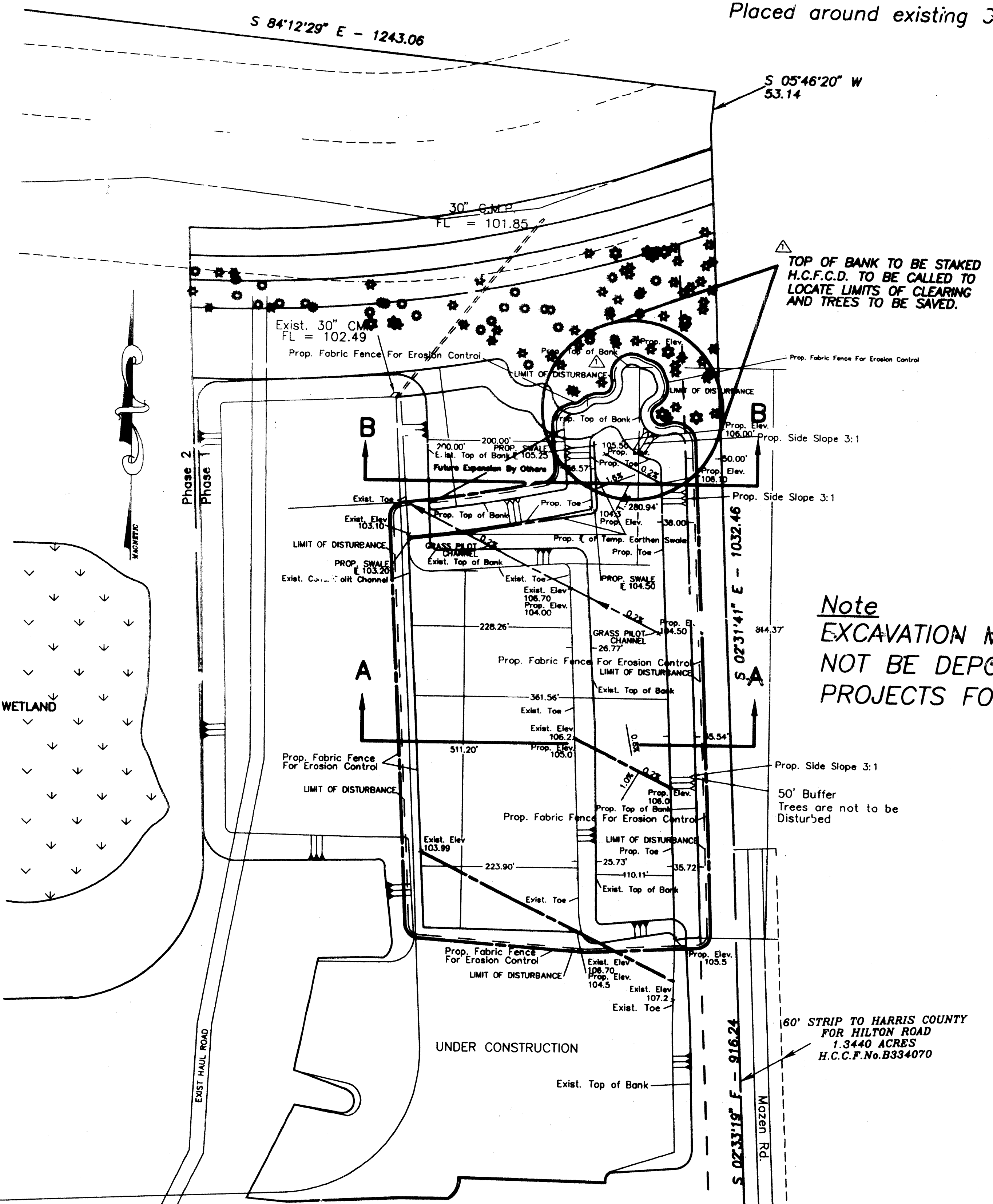

- HARRIS COUNTY FLOOD CONTROL DISTRICT, WATERSHED MANAGEMENT DEPARTMENT, SHALL BE NOTIFIED AT LEAST 48 HOURS PRIOR TO CONSTRUCTION (713/684-4050). A COPY OF THE APPROVED CONSTRUCTION DRAWINGS IS REQUIRED AT THIS TIME.
- ENGINEER SHALL SUBMIT LETTER AND RECORD DRAWINGS TO HARRIS COUNTY FLOOD CONTROL DISTRICT, WATERSHED MANAGEMENT DEPARTMENT, REQUESTING INSPECTION AND ACCEPTANCE OF ITEMS CONSTRUCTED IN HARRIS COUNTY FLOOD CONTROL DISTRICT RIGHT OF WAY. PRIOR TO REQUESTING INSPECTION, THE DRAINAGE RIGHT OF WAY AND/OR EASEMENTS SHALL BE STAKED AND FLAGGED.
- CONTRACTOR SHALL BE RESPONSIBLE FOR PROTECTING, MAINTAINING AND RESTORING BACKSLOPE DRAINAGE SYSTEMS.
- ALL DISTURBED AREAS WITHIN THE HARRIS COUNTY FLOOD CONTROL DISTRICT RIGHT OF WAY, INCLUDING THE DETENTION BASIN BOTTOM, SHALL BE SEED AS PER HARRIS COUNTY FLOOD CONTROL SPECIFICATION PART IV, SECTION 15, ENTITLED "TURF ESTABLISHMENT".
- BACKFILL TO BE COMPACTED IN NO GREATER THAN 1 FOOT LIFTS TO THE DENSITY OF THE UNDISTURBED ADJACENT SOIL.
- CONTRACTOR SHALL BE RESPONSIBLE FOR EXCAVATING CHANNEL FLOWLINE TO DESIGN ELEVATION AS SHOWN ON PLANS AND DOWN STREAM AS NECESSARY TO INSURE NO WATER IN STORM SEWER DURING "DRY" CONDITIONS.
- CONTRACTOR SHALL BE RESPONSIBLE FOR MAINTAINING FLOW IN CHANNEL DURING CONSTRUCTION AND RESTORING CHANNEL TO ORIGINAL CONDITION.
- ALL EXCAVATED MATERIAL IS TO BE REMOVED FROM THE HCFCD RIGHT OF WAY. NO FILL IS TO BE PLACED WITHIN A DESIGNATED FLOOD PLAIN AREA WITHOUT FIRST OBTAINING A FILL PERMIT.
- CONTRACTOR WITH THE ASSISTANCE OF THE ENGINEER IF NECESSARY, SHALL BE RESPONSIBLE FOR OBTAINING ALL APPLICABLE CITY, COUNTY, STATE, AND FEDERAL PERMITS.
- NO EXCAVATION MATERIAL CAN BE PLACE WITHIN S.H.249 OR F.M. 1960 R.O.W.
- ACTUAL SITE CONDITIONS MAY VARY AT THE TIME OF CONSTRUCTION FROM THOSE SHOWN HEREON. THE CONTRACTOR IS TO COORDINATE WITH THE DESIGN ENGINEER AND HARRIS COUNTY FLOOD CONTROL DISTRICT ENGINEER TO DETERMINE ANY REVISIONS IN THE SCOPE OF WORK.

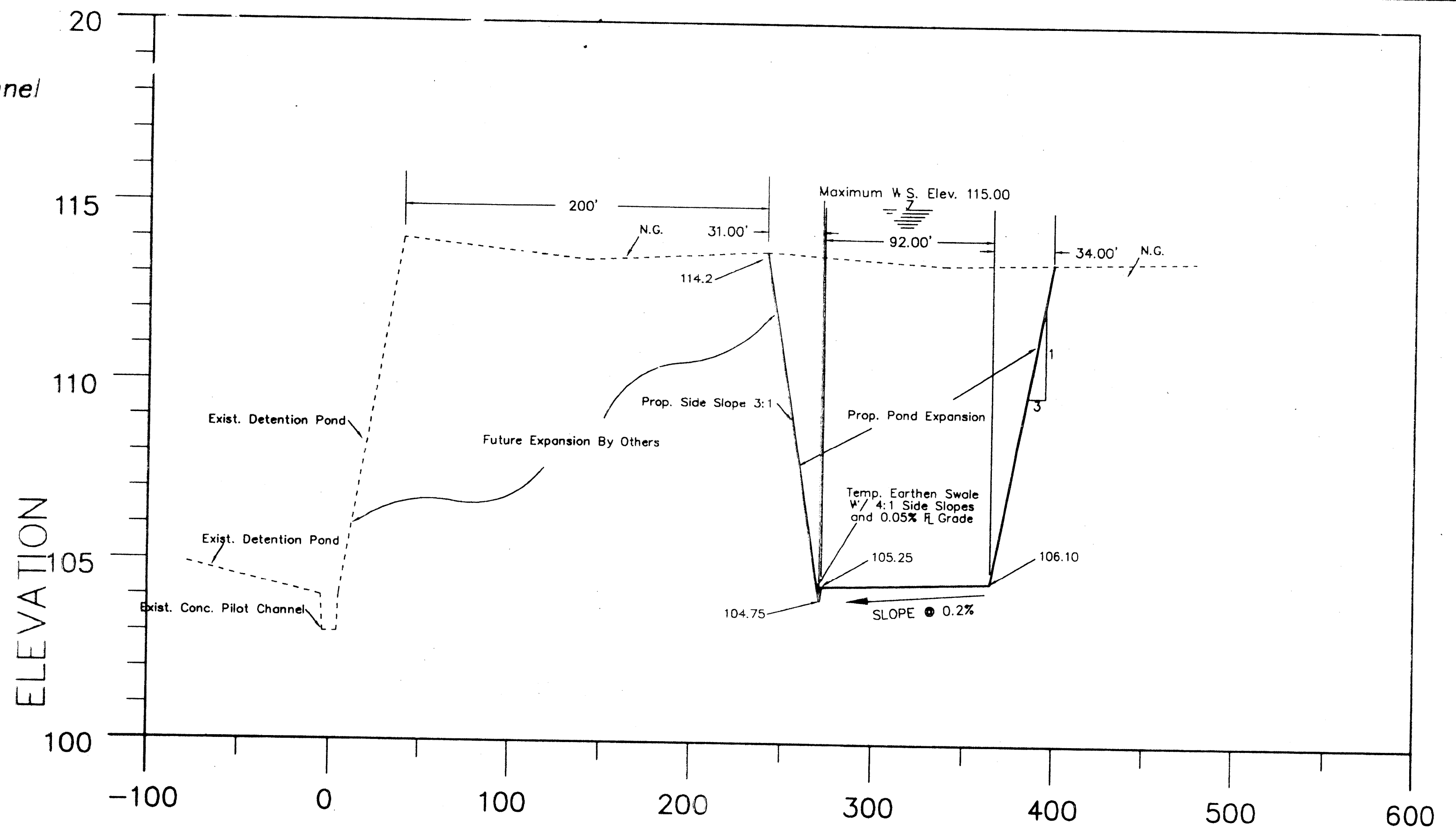

SECTION B-B
SCALE
H: 1" = 50' V: 1" = 2.5"

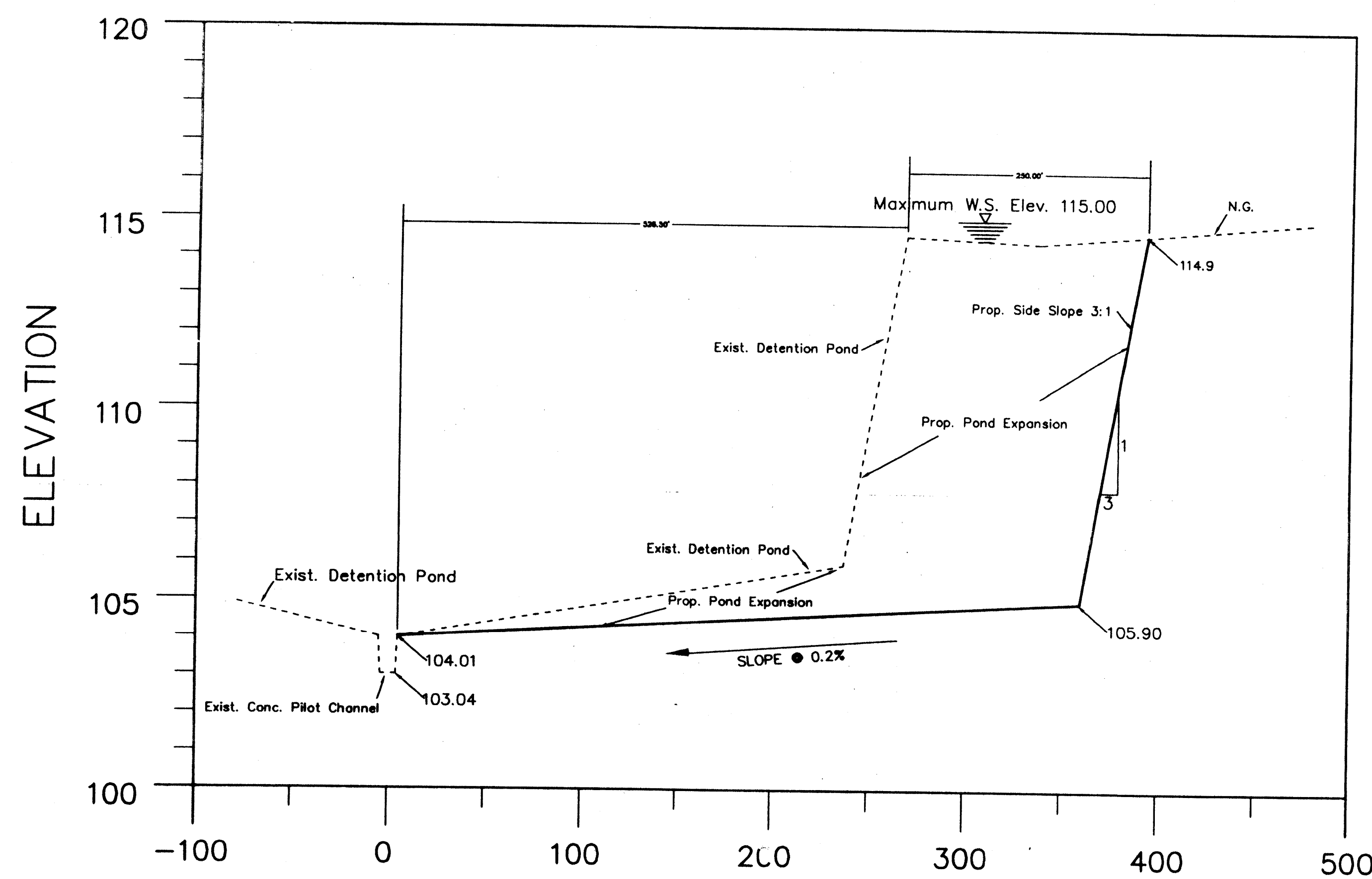

SECTION A-A
SCALE
H: 1" = 50' V: 1" = 2.5"

△			
△	7/11/96	Area of pond moved to save trees	MVB
Rev.	Date	Description	App.

**SPRING CREEK OAKS
DETENTION POND**

SITE DETAIL

Job No.: 450
Scales: Horiz: 1" = 100'
Vert: 1" = 100'
Date: NOVEMBER 1995
Design By: MVB
Drawn By: MVB
Check By: MVB
Sheet No.: 4 of 5

PROVIDENT ENGINEERS, INC.
12200 N.W. FRWY, Suite 210
Houston, Texas 77092