

DODSON RD.

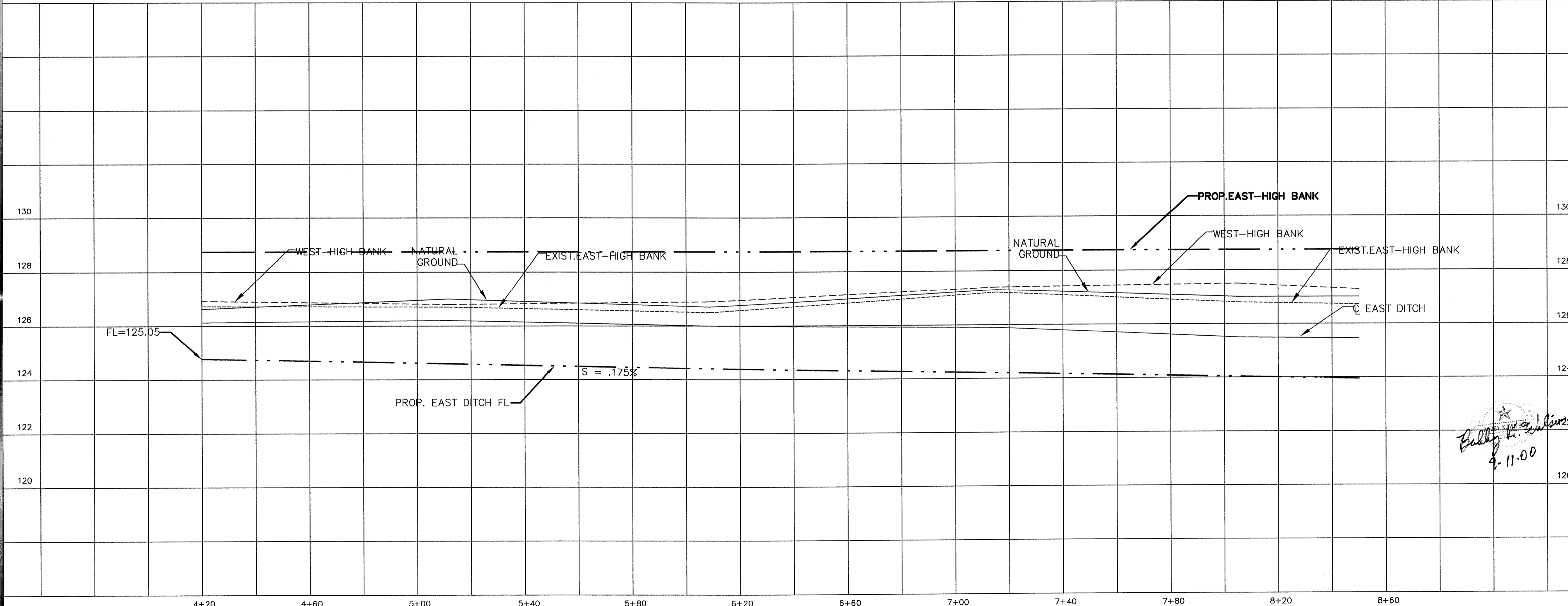

**BENCH MARK**

BENCH MARK: NATIONAL GEODETIC SURVEY MARKER  
 Y1216, 1973 ADJ. ELEV. = 125.994  
 Y1216, 1978 ADJ. ELEV. = 125.406  
 Y1216, 1988 ADJ. ELEV. = 125.94 (THIS ADJUSTMENT WAS USED FOR CUTTEN ROAD)

ELEVATIONS SHOWN HEREON ARE BASED ON 1973 ADJUSTMENT

TBM #1: SET RAILROAD SPIKE ON SOUTH SIDE OF 14" TALLOW APPROXIMATELY 31 FEET NORTH OF THE END OF CENTERFIELD DRIVE  
 ELEVATION = 128.60

TBM #2: SET RAILROAD SPIKE ON SOUTH SIDE OF POWER POLE WITH TRANSFORMER ON WEST SIDE OF PRIVATE ROAD AND 200 FEET NORTH OF PRIVATE ROAD  
 ELEVATION = 130.62

TBM #3: SET RAILROAD SPIKE ON EAST SIDE OF POWER POLE ON WEST SIDE OF HARGRAVE ROAD AND NORTH OF THE INTERSECTION OF DOTSON ROAD & HARGRAVE ROAD  
 ELEVATION = 128.04

TBM #4: RAILROAD SPIKE ON EAST SIDE OF POWER POLE #13629 ON THE WEST SIDE OF HARGRAVE ROAD APPROXIMATELY 30 FEET NORTH OF 18 INCH R.C.P. AT GRAVEL DRIVE FROM 13627 HARGRAVE ROAD  
 ELEVATION = 130.56

**NOTE:**  
 THIS TRACT IS IN ZONE "X" AS PER FEMA FLOOD INSURANCE RATE MAP PANEL NO. 462010245 K, HARRIS COUNTY, TX, REVISED APRIL 20, 2000. ZONE "X" IS DESCRIBED AS BEING OUTSIDE THE 500 YEAR FLOODPLAIN.

APPROVED: *[Signature]*  
 for Assistant County Engineer  
*[Signature]*  
 Date

Approved implied for paving and drainage facilities within Harris County R.O.W. and/or jurisdiction. All other improvements in H.C.R.O.W. and/or jurisdiction are approved as to location only.  
 The above authorization is valid for one (1) year only.

Rev.	Date	Description	App.

**PRIVATE UTILITY LINES SHOWN**

*[Signature]* 9/18/00  
 RELIANT ENERGY INC./ENTEX

*[Signature]* 9/18/00  
 SOUTHWESTERN BELL TELEPHONE CO.  
 Valid for One Year Only

*[Signature]* 9/18/00  
 RELIANT ENERGY INC./H.L.&P.  
 Approval Only for Crossing Underground  
 Ductlines Unless Noted. Valid at Time of Review Only.

**CITY OF HOUSTON**  
 DEPARTMENT OF PUBLIC WORKS AND ENGINEERING

REVIEWED BY	
PRIVATELY FUNDED PUBLIC WORKS	CITY FUNDED PUBLIC WORKS
<i>[Signature]</i> 9-18-00 WATER	PROJECT MANAGER
<i>[Signature]</i> 9/18/00 WASTEWATER	CONSTRUCTION
<i>[Signature]</i> 9/18/00 STORM WATER	CHIEF ENGINEER
STREET AND BRIDGE	OTHER APPROVAL
TRAFFIC AND TRANSPORTATION	SPONSOR DEPARTMENT

CITY ENGINEER \_\_\_\_\_ DATE \_\_\_\_\_  
 DIRECTOR OF PUBLIC WORKS AND ENGINEERING *[Signature]* 9-18-2000 DATE

SUBMITTED: \_\_\_\_\_ DESIGNED BY: B K WILSON  
 SCALE:  $V - 1" = 2'$  DRAWN BY: BILL DORRIS  
 $H - 1" = 20'$   
 DATE: 05/10/00 SHEET NO. 13 OF 15 SHEETS  
 SURVEY BY: \_\_\_\_\_ CITY DWG. NO. DRPP2.DWG  
 JOB NO: 481

*[Signature]*  
 9-11-00

HARRIS COUNTY MUD 191  
 DETENTION POND  
 to serve  
 CHAMPIONS ARBOR  
 PLAN & PROFILE  
 of  
 DOTSON RD.  
 2' X 4' BOX CULERT  
 STA. 4+20 to STA. 8+50

**PCI** PROVIDENT CONSULTING, INC.  
 1200 WEST 11TH ST.  
 HOUSTON, TEXAS 77008  
 (713)802-1019