

A c r e a g e

WATER LINES, WASTEWATER COLLECTION SYSTEMS, SHALL BE CONSTRUCTED AND TESTED IN ACCORDANCE WITH THE CITY OF HOUSTON, DEPARTMENT OF PUBLIC WORKS AND ENGINEERING'S "STANDARD CONSTRUCTION SPECIFICATIONS" DATED SEPTEMBER 1997, AND "STANDARD CONSTRUCTION DETAILS FOR WASTEWATER COLLECTION SYSTEMS, WATER LINES, STORM DRAINAGE AND STREET PAVING" DATED JULY 1997 UNLESS OTHERWISE NOTED AND APPROVED ON THESE PLANS. THE DESIGN IS CONSISTENT WITH THE MINIMUM STANDARDS ESTABLISHED IN THE "DESIGN MANUAL FOR WASTEWATER COLLECTION SYSTEMS, WATER LINES, STORM DRAINAGE AND STREET PAVING" DATED OCTOBER 1999.

"CONTRACTOR SHALL NOTIFY THE CITY OF HOUSTON, DEPARTMENT OF PUBLIC WORKS AND ENGINEERING, ENGINEERING CONSTRUCTION DIVISION (TELEPHONE NO. 713-837-7000) 48 HOURS BEFORE STARTING WORK ON THIS PROJECT."

"PRIOR TO THE CONSTRUCTION OF THESE FACILITIES WITHIN OR BY THE DISTRICT, THE DISTRICT OR ITS ENGINEER WILL GIVE WRITTEN NOTICE BY THE REGISTERED OR CERTIFIED MAIL TO THE DIRECTOR OF PUBLIC WORKS AND ENGINEERING STATING THE DATE SUCH CONSTRUCTION WILL BE COMMENCED."

THE CONTRACTOR SHALL BE FULLY RESPONSIBLE FOR ANY AND ALL DAMAGE TO THE EXISTING PUBLIC OR PRIVATE UTILITY LINES, INCLUDING BUT NOT LIMITED TO WATER LINES, WASTEWATER COLLECTION SYSTEMS AND STORM SEWERS, DURING CONSTRUCTION. ALL DAMAGES SHALL BE REPAIRED IN ACCORDANCE WITH CITY OF HOUSTON, DEPARTMENT OF PUBLIC WORKS AND ENGINEERING "STANDARD CONSTRUCTION SPECIFICATIONS" WITH LATEST ADDENDA AND AMENDMENTS THERETO, WITH NO COST TO THE PUBLIC.

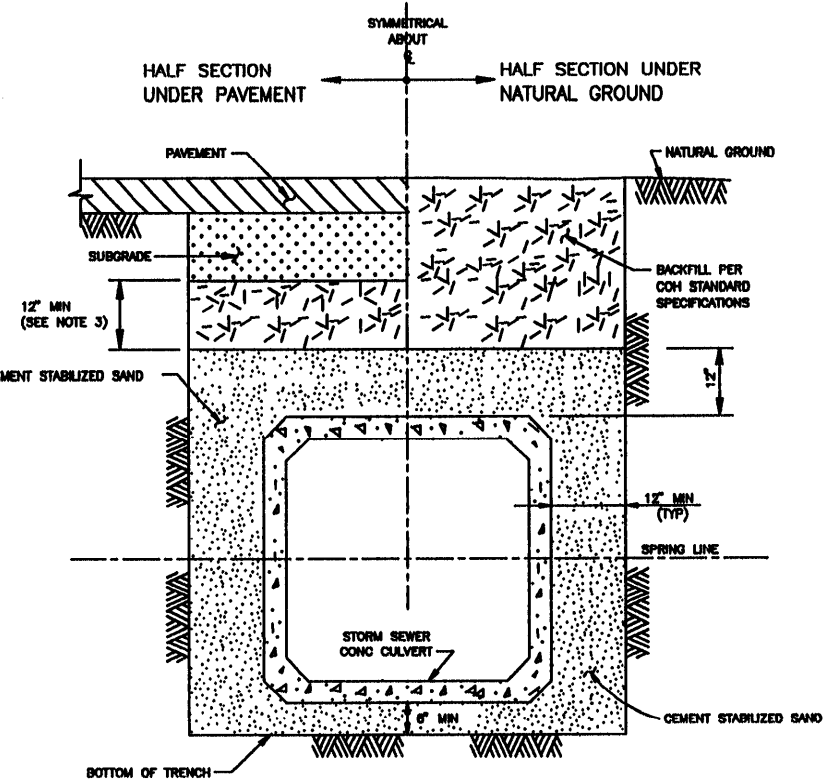

- NOTES:
- WHERE MULTIPLE BOX SEWERS ARE USED IN THE SAME TRENCH, MIN OUTSIDE TO OUTSIDE BOX SEWER SEPARATION SHALL BE 4'.
 - THE DETAIL TO BE USED ONLY WHERE SOIL CONDITIONS ARE SATISFACTORY.
 - SELECT SHOULDER FOR ROAD PAVEMENTS: PLEASE SEE MANUAL FOR IMPACT PAVEMENT.
- STORM SEWER BEDDING AND BACKFILL FOR PRECAST CONCRETE BOX WHERE SATISFACTORY SOIL CONDITIONS EXIST (NOT TO SCALE)
 DTF STD. AA-01-07 DWS INC. 02317-05

DODSON RD.

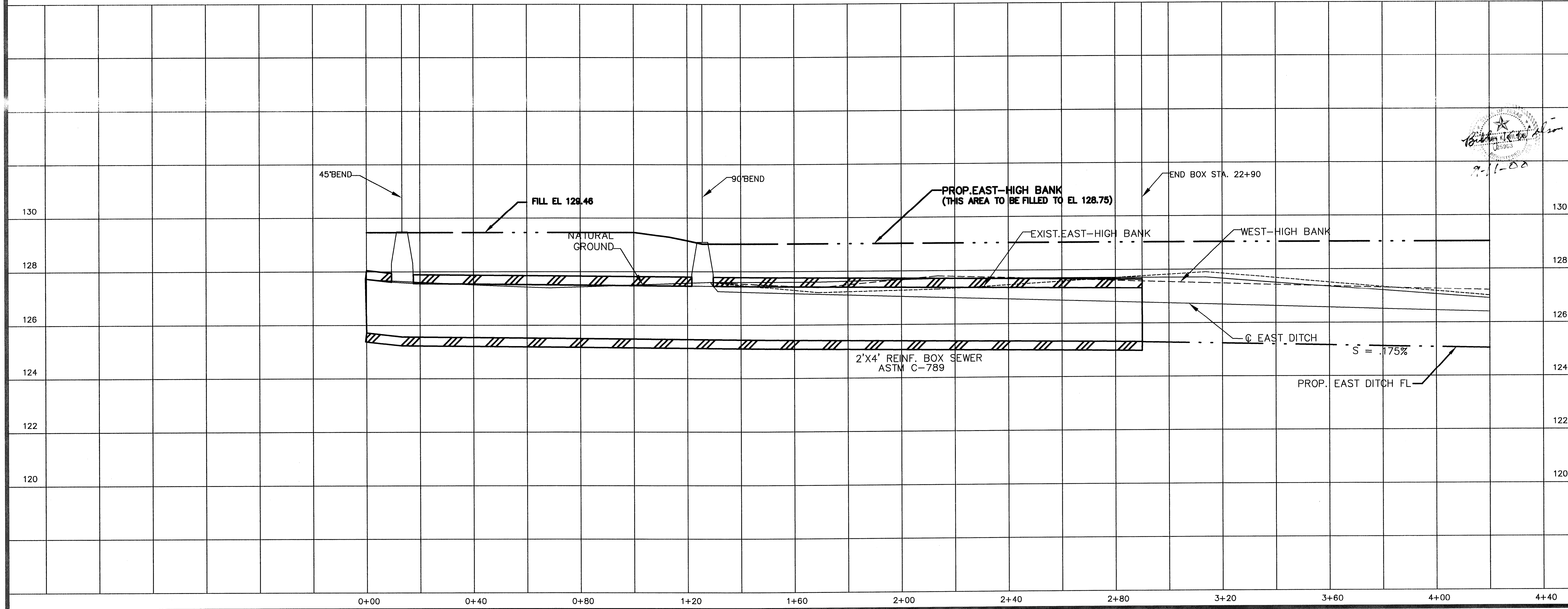

BENCH MARK

BENCH MARK: NATIONAL GEODETIC SURVEY MARKER
 Y1216, 1973 ADJ., ELEV. = 125.984
 Y1218, 1978 ADJ., ELEV. = 125.406
 Y1216, 1988 ADJ., ELEV. = 123.94 (THIS ADJUSTMENT WAS USED FOR CUTTEN ROAD)

ELEVATIONS SHOWN HEREON ARE BASED ON 1973 ADJUSTMENT

TBM #1: SET RAILROAD SPIKE ON SOUTH SIDE OF 14" TALLOW APPROXIMATELY 31 FEET NORTH OF THE END OF CENTERFIELD DRIVE ELEVATION = 128.60

TBM #2: SET RAILROAD SPIKE ON SOUTH SIDE OF POWER POLE WITH TRANSFORMER ON WEST SIDE OF PRIVATE ROAD AND 200 FEET NORTH OF PRIVATE ROAD ELEVATION = 130.62

TBM #3: SET RAILROAD SPIKE ON EAST SIDE OF POWER POLE ON WEST SIDE OF HARGRAVE ROAD AND NORTH OF THE INTERSECTION OF DOTSON ROAD & HARGRAVE ROAD ELEVATION = 128.04

TBM #4: RAILROAD SPIKE ON EAST SIDE OF POWER POLE #13629 ON THE WEST SIDE OF HARGRAVE ROAD APPROXIMATELY 30 FEET NORTH OF 18 INCH R.C.P. AT GRAVEL DRIVE FROM 13627 HARGRAVE ROAD ELEVATION = 130.56

APPROVED: *[Signature]*
 for Assistant County Engineer
 30th 2000
 Date

Approved implied for paving and drainage facilities within Harris County R.O.W. and/or jurisdiction. All other improvements in H.C.R.O.W. and/or jurisdiction are approved as to location only. The above authorization is valid for one (1) year only.

Rev.	Date	Description	App.

PRIVATE UTILITY LINES SHOWN

<i>R. Young</i>	9/18/00
RELIANT ENERGY, INC./ENTEX	
<i>[Signature]</i>	9/18/00
SOUTHWESTERN BELL TELEPHONE CO.	
Valid for One Year Only	
<i>R. Young</i>	9/18/00
RELIANT ENERGY, INC./H.L.&P.	
Approval Only for Crossing Underground	
Ductlines Unless Noted. Valid at Time of Review Only.	

CITY OF HOUSTON
 DEPARTMENT OF PUBLIC WORKS AND ENGINEERING

REVIEWED BY

PRIVATELY FUNDED PUBLIC WORKS	CITY FUNDED PUBLIC WORKS
<i>[Signature]</i> WATER	<i>[Signature]</i> PROJECT MANAGER
<i>[Signature]</i> WASTEWATER	<i>[Signature]</i> CONSTRUCTION
<i>[Signature]</i> STORM WATER	<i>[Signature]</i> CHIEF ENGINEER
STREET AND BRIDGE	
OTHER APPROVAL	
TRAFFIC AND TRANSPORTATION	SPONSOR DEPARTMENT
CITY ENGINEER	DATE
<i>[Signature]</i>	9-18-2000
DIRECTOR OF PUBLIC WORKS AND ENGINEERING	DATE
SUBMITTED: V - 1" = 2" SCALE: H - 1" = 20"	DESIGNED BY: B K WILSON
DATE: 05/10/00	DRAWN BY: BILL DORRIS
SURVEY BY:	SHEET NO. 12 OF 15 SHEETS
JOB NO: 481	CITY DWG. NO. DRPPI.DWG

HARRIS COUNTY MUD 191
 DETENTION POND
 to serve
 CHAMPIONS ARBOR
 PLAN & PROFILE
 of
 DOTSON RD.
 2' x 4' BOX CULVERT
 STA. 0+00 to STA. 4+20

PCI PROVIDENT CONSULTING, INC.
 PROVIDENT CONSULTING, INC.
 1200 WEST 11TH ST.
 HOUSTON, TEXAS 77008
 (713)802-1019