

BENCH MARK

BENCH MARK: NATIONAL GEODETIC SURVEY MARKER
Y1216, 1973 ADJ., ELEV = 125.994
Y1216, 1978 ADJ., ELEV = 125.406
Y1216, 1988 ADJ., ELEV = 123.94 ADJUSTMENT
USED FOR CUTTEN ROAD.

ELEVATIONS SHOWN HEREON ARE BASED ON 1973
ADJUSTMENT.

TBM#1: TOP OF CURB AT CENTERLINE INLET NORTH
SIDE OF TOURNAMNET DRIVE AT CENTERLINE
QUEENSCULUB DRIVE ELEV. = 114.69

APPROVED: *Castie J. Jaraman*
Assistant County Engineer
2/16/98
Date

Water & Sanitary Sewer Lines Approved as to
Location Only
The Above Authorization is Valid for 1 Year
Only

Rev	Date	Description	App.

PRIVATE UTILITY LINES SHOWN

- ENIX, INC.
- SOUTHWESTERN BELL TELEPHONE CO.
Valid for One Year Only
- HOUSTON LIGHTING & POWER CO.
Approval Only for Crossing Underground
Ductlines Unless Noted. Valid at Time of Review Only.

CITY OF HOUSTON
DEPARTMENT OF PUBLIC WORKS & ENGINEERING
ENGINEERING, CONSTRUCTION AND REAL ESTATE GROUP

TRAFFIC AND SIGNAL ENGINEERING
John Kola 12-9-97
STREET & BRIDGE ENGINEERING
Tom Thomas 1-9-98
CONSTRUCTION
Steve 12/22/97

OTHER DEPARTMENT APPROVALS:

PLANNING AND DEVELOPMENT SPONSOR DEPARTMENT

CITY ENGINEER DATE 1/15/98

DIRECTOR OF PUBLIC WORKS AND ENGINEERING DATE 1-16-98

SUBMITTED: 1" = 2'
SCALE: 1/2" = 20'
DATE: AUGUST 1997
SURVEY BY:
CITY DWG. NO.

M.U.D. 191
PLAN & PROFILE
CUTTEN RD.
STA. 164+00 TO 169+00

PEI PROVIDENT ENGINEERS, INC.
11241 RICHMOND, SUITE E107
HOUSTON, TEXAS 77082

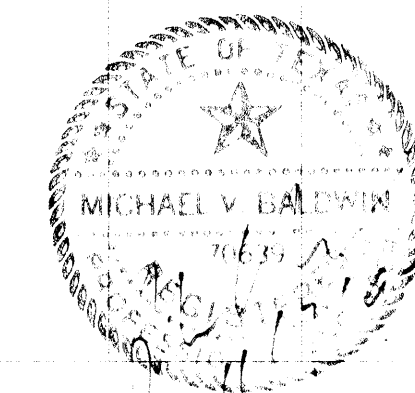
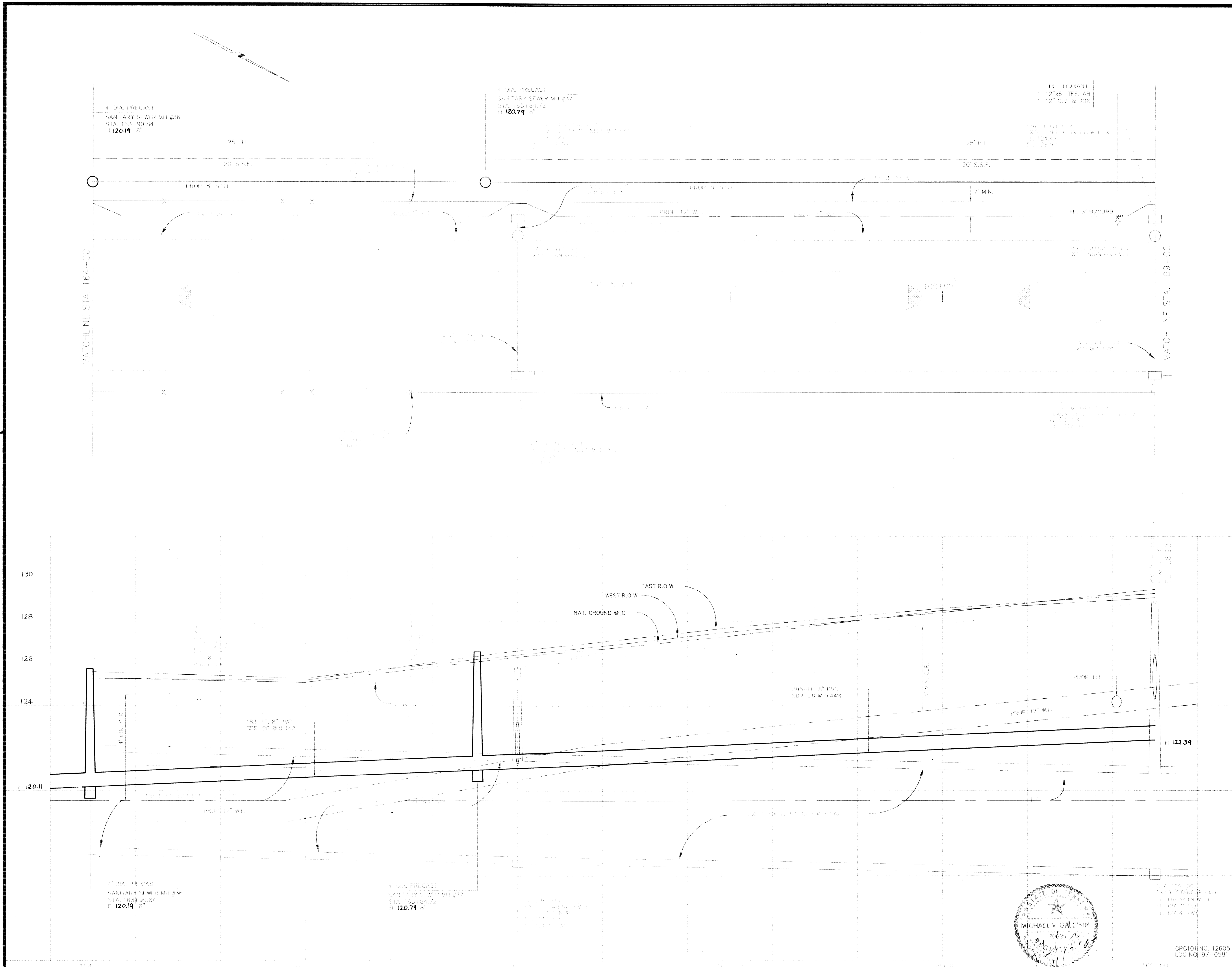

CPC101 NO. 12605
LOG NO. 97-0581