

ARON COURT

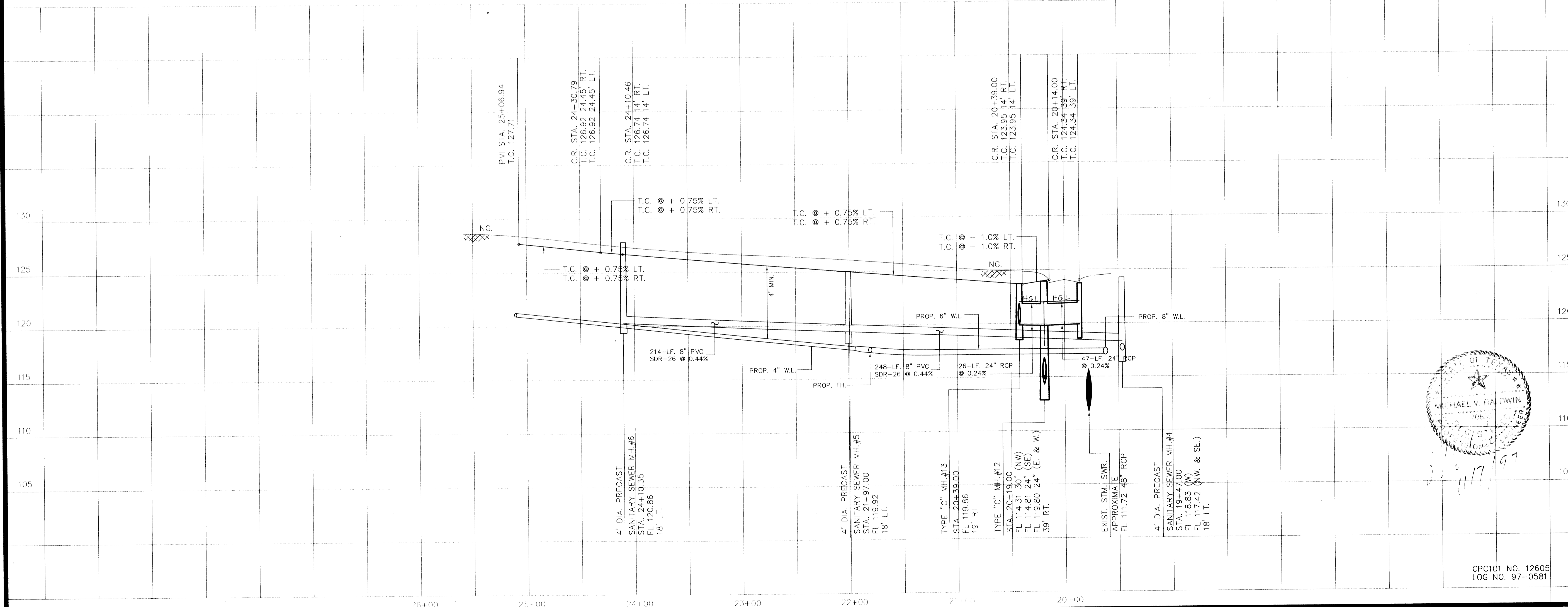

BENCH MARK
 NATIONAL GEODETIC SURVEY MARKER
 Y1216, 1973 ADJ., ELEV = 125.994
 Y1216, 1978 ADJ., ELEV = 125.906
 Y1216, 1988 ADJ., ELEV = 123.94 ADJUSTMENT USED FOR CUTTEN ROAD.
 ELEVATIONS SHOWN HEREON ARE BASED ON 1973 ADJUSTMENT.
 TBM#1: TOP OF CURB AT CENTERLINE INLET NORTH SIDE OF TOURNAMENT DRIVE AT CENTERLINE QUEENSLUB DRIVE ELEV. = 114.69

APPROVED: *Cedric Freeman*
 Assistant County Engineer
 2/16/98
 Date

Water & Sanitary Sewer Lines Approved as to Location Only
 The Above Authorization is Valid for 1 Year Only

Rev.	Date	Description	App.

PRIVATE UTILITY LINES SHOWN

- ENTEX, INC.
- SOUTHWESTERN BELL TELEPHONE CO. Valid for One Year Only
- HOUSTON LIGHTING & POWER CO. Approval Only for Crossing Underground Ductlines Unless Noted. Valid at Time of Review Only.

CITY OF HOUSTON
 DEPARTMENT OF PUBLIC WORKS & ENGINEERING
 ENGINEERING, CONSTRUCTION AND REAL ESTATE GROUP

SECTION APPROVALS

<i>[Signature]</i> 12/29/97 WATER ENGINEERING	TRAFFIC AND SIGNAL ENGINEERING
<i>[Signature]</i> 1/16/98 WASTEWATER ENGINEERING	STREET & BRIDGE ENGINEERING
<i>[Signature]</i> 12/22/97 STORM SEWER ENGINEERING	CONSTRUCTION

OTHER DEPARTMENTS

PLANNING AND DEVELOPMENT	SPONSOR DEPARTMENT
<i>[Signature]</i> CITY ENGINEER	DATE 1/15/98
<i>[Signature]</i> DIRECTOR OF PUBLIC WORKS AND ENGINEERING	DATE 1-16-98

SUBMITTED: V. 1" = 5'	DESIGNED BY: TIM
SCALE: H. 1" = 50'	DRAWN BY: TIM
DATE: AUGUST 1997	SHEET NO. 16 OF 27 SHEETS
SURVEY BY:	CITY DWG. NO:
F B NO:	

M.U.D. 191
 PLAN & PROFILE
 ARON COURT

PROVIDENT ENGINEERS, INC.
 11241 RICHMOND, SUITE E107
 HOUSTON, TEXAS 77082

CPC101 NO. 12605
 LOG NO. 97-0581