

THE 100-YEAR FLOOD PLAN PER F.I.R.M. MAP COMMUNITY PANEL No. 48201C0435L, DATED SEPT. 30, 2004, AND IS DESIGNATED TO BE IN ZONE "X".

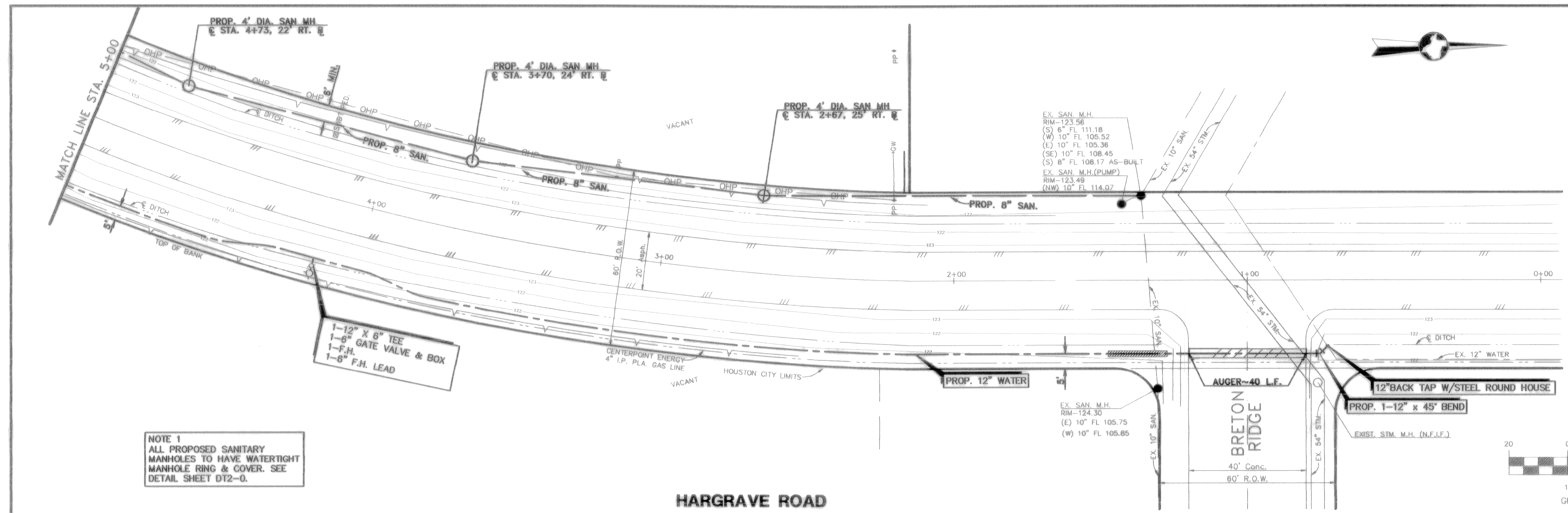
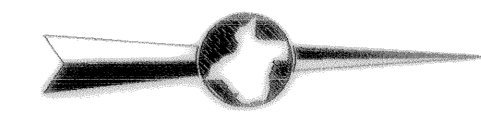

NOTE 1
ALL PROPOSED SANITARY MANHOLES TO HAVE WATERTIGHT MANHOLE RING & COVER. SEE DETAIL SHEET DT2-0.

STANDARD PROFILE LEGEND

CENTER LINE OF R.O.W.	---
PROPERTY LINE N & E	----
PROPERTY LINE S & W	----
DITCH OR CURB N & E	----
DITCH OR CURB S & W	----

AT LEAST 48 HOURS BEFORE EXCAVATING IN STREET R.O.W. OR EASEMENTS CALL UTILITY COORDINATING COMMITTEE. 1-800-245-4545

PRIVATE UTILITY LINES SHOWN

CenterPoint Energy/ Gas Facilities
 S.B.C. VALID FOR ONE YEAR
 APPROVED ONLY FOR CROSSING UNDERGROUND DUCTILES UNLESS NOTED. VALID AT TIME OF REVIEW ONLY.
 CenterPoint Energy/ Electric Facilities
 APPROVED ONLY FOR CROSSING UNDERGROUND DUCTILES UNLESS NOTED. VALID AT TIME OF REVIEW ONLY.
 CABLE COMPANY

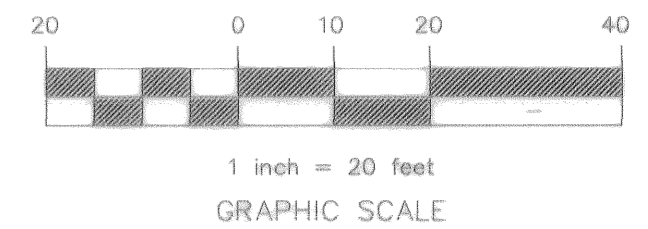
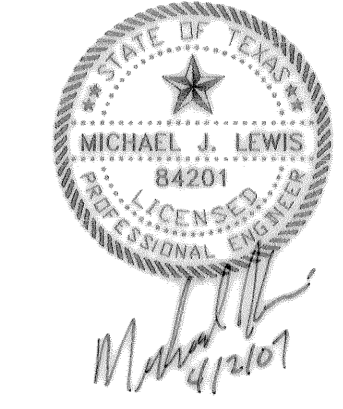

HARGRAVE ROAD



NOTE:
LOCATIONS OF EXISTING UTILITY LINES ARE BASED ON AVAILABLE CONSTRUCTION PLANS.

AS-BUILTS 3-16-07

App.	Revisions	Date	No.
ASBUILT		4-2-07	

T.B.M.: TOP OF FIRE HYDRANT @ STA. 0+84.82, 174.17' LT. @ HARGRAVE ELEV.=126.67
 REFERENCE BENCHMARK #AW5011 TO REACH THE STATION FROM THE INTERSECTION OF FARM ROAD 1960 AND FARM ROAD 149, WHICH IS ABOUT 27.4 KM (17.0 MI) NORTHWEST OF HOUSTON, GO NORTHEAST ON FARM ROAD 1960 FOR 1.0 KM(0.6 MI) TO A SIDE ROAD LEFT, TURN LEFT, ON BRETON RIDGE ROAD FOR ABOUT 30.5 METERS (100 FT) TO THE STATION ON THE RIGHT. THE STATION IS A PUNCH MARK IN THE TOP OF A STAINLESS STEEL ROD DRIVEN INTO THE GROUND AND INSIDE A 1-INCH PVC PIPE THAT IS 20 FEET LONG FILLED WITH GREASE THAT IS ENCASED IN A 5-INCH PVC PIPE WITH A LOGO CAP STAMPED---HOCSB 11 1986---. THE ROD IS RECESSED 8 CM BELOW THE GROUND, LOCATED 35.4 METERS (116.0 FT) NORTHEAST FROM A FIRE HYDRANT THAT IS ACROSS BRETON RIDGE ROAD, 30.8 METERS (101.0 FT) NORTHWEST FROM A RED GRANITE WALL AND 9.9 METERS (32.6 FT) NORTHEAST FROM THE NORTHEAST CURB OF BRETON RIDGE ROAD ELEV.=121.3 NGS DATUM (1988 ADJ.)

MUNICIPAL UTILITY DISTRICT NO. 191
HARGRAVE ROAD
 PROP. SANITARY SEWER AND WATER EXTENSION.

ASPEN CIVIL DESIGN

(832) 907-5051 14019 S.W. Parkway, Suite 301-278 Sugar Land, Texas 77478 (281) 265-3551 Fax

CITY OF HOUSTON
 DEPARTMENT OF PUBLIC WORKS AND ENGINEERING

WATER	WASTEWATER	TRAFFIC
ST. & BRIDGE	STORMWATER	SWG

FILE NO.: 225P1
 DRAWING SCALE:
 VERT: 1"=20'
 HORIZ: 1"=20'
 SHEET:
 4 OF 10