

THE 100-YEAR FLOOD PLAN PER F.I.R.M. MAP COMMUNITY PANEL No. 48201C0435L, DATED SEPT. 30, 2004, AND IS DESIGNATED TO BE IN ZONE "X".

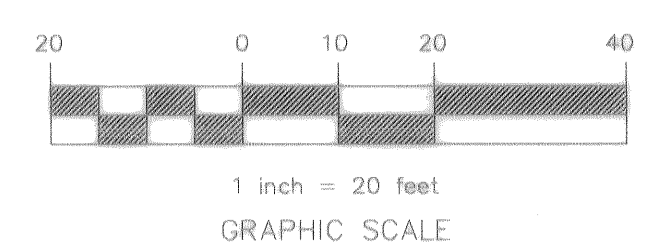

LEGEND

- PLACE 1-20 FOOT JOINT OF C-900 PVC, 150 PSI, CENTERED ON SANITARY SEWER, 2-FOOT ABSOLUTE MINIMUM CLEARANCE.
- CENTER 18-FOOT JOINT OF SANITARY SEWER, 150 PSI LINED DUCTILE IRON PIPE OR PVC CENTERED AT THE WATER LINE; 6-INCH ABSOLUTE MINIMUM CLEARANCE.

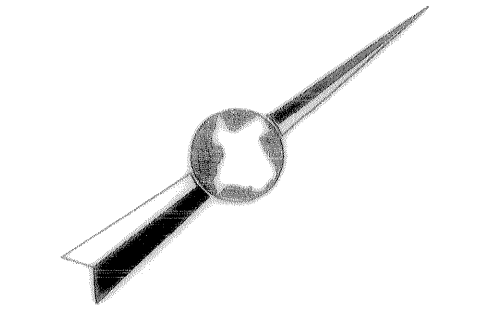
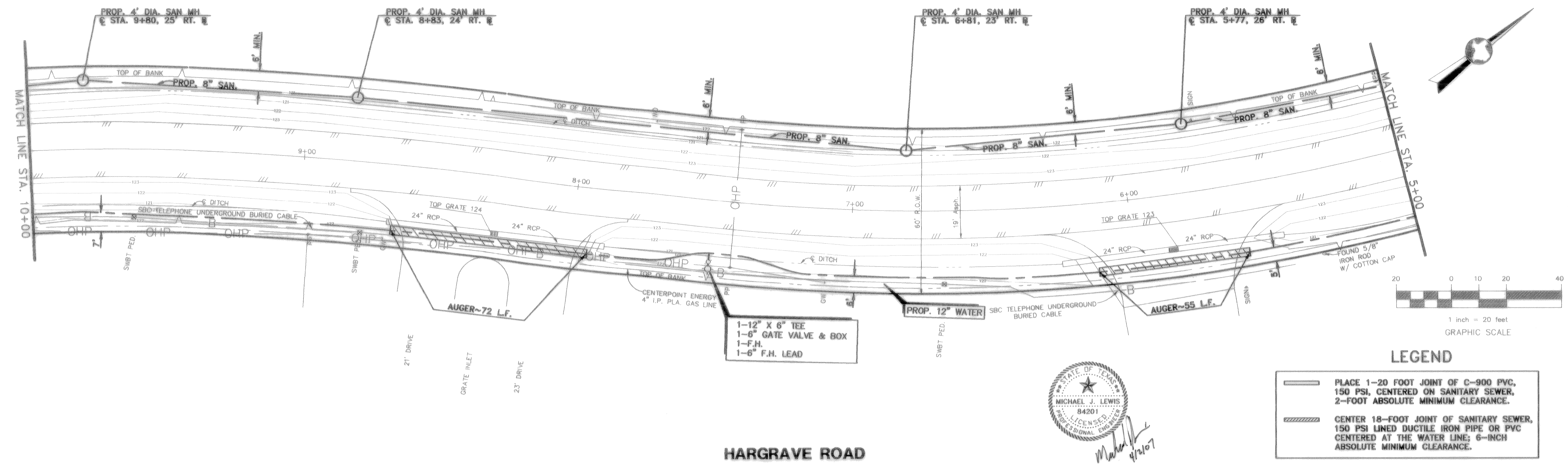
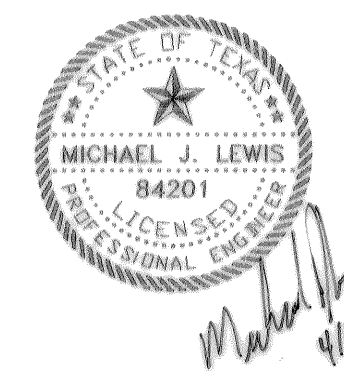

HARGRAVE ROAD



STANDARD PROFILE LEGEND

CENTER LINE OF R.O.W.	_____
PROPERTY LINE N & E	_____
PROPERTY LINE S & W	_____
DITCH OR CURB N & E	_____
DITCH OR CURB S & W	_____

AT LEAST 48 HOURS BEFORE EXCAVATING IN STREET R.O.W. OR EASEMENTS CALL UTILITY COORDINATING COMMITTEE. 1-800-245-4545

PRIVATE UTILITY LINES SHOWN

CenterPoint Energy/ Gas Facilities

S.B.C. VALID FOR ONE YEAR
APPROVED ONLY FOR CROSSING UNDERGROUND DUCTLINES UNLESS NOTED. VALID AT TIME OF REVIEW ONLY.

CenterPoint Energy/ Electric Facilities
APPROVED ONLY FOR CROSSING UNDERGROUND DUCTLINES UNLESS NOTED. VALID AT TIME OF REVIEW ONLY.

CABLE COMPANY

NOTE:
LOCATIONS OF EXISTING UTILITY LINES ARE BASED ON AVAILABLE CONSTRUCTION PLANS.

AS-BUILTS 3-16-07

App.	Revisions	Date	No.
ASBUILT		4-2-07	

T.B.M. TOP OF FIRE HYDRANT @ STA. 0+84.82, 174.17' L.T. @ HARGRAVE ELEV.=126.67
REFERENCE BENCHMARK JAW5511 TO REACH THE STATION FROM THE INTERSECTION OF FARM ROAD 1960 AND FARM ROAD 149, WHICH IS ABOUT 27.4 KM (17.0 MI) NORTHWEST OF HOUSTON, GO NORTHEAST ON FARM ROAD 1960 FOR 1.0 KM(0.6 MI) TO A SIDE ROAD LEFT, TURN LEFT, ON BRETON RIDGE ROAD FOR ABOUT 30.5 METERS (100 FT) TO THE STATION ON THE RIGHT. THE STATION IS A PUNCH MARK IN THE TOP OF A STAINLESS STEEL ROD DRIVEN INTO THE GROUND AND INSIDE A 1-INCH PVC PIPE THAT IS 20 FEET LONG FILLED WITH GREASE THAT IS ENCASED IN A 5-INCH PVC PIPE WITH A LOG GAP STAMPED: HCS11 1986. THE ROD IS RECESSED 8 CM BELOW THE GROUND, LOCATED 35.4 METERS (116.0 FT) NORTHEAST FROM A FIRE HYDRANT THAT IS ACROSS BRETON RIDGE ROAD, 30.8 METERS (101.0 FT) NORTHWEST FROM A RED GRANITE WALL AND 9.9 METERS (32.6 FT) NORTHEAST FROM THE NORTHEAST CURB OF BRETON RIDGE ROAD. ELEV.=121.3 NGS DATUM (1988 ADJ.)

MUNICIPAL UTILITY DISTRICT NO. 191
HARGRAVE ROAD
PROP. SANITARY SEWER AND WATER EXTENSION.

ASPEN CIVIL DESIGN
(832) 607-3551 14019 S.W. Freeway, Suite 301-278
(281) 265-3551 Fax Sugar Land, Texas 77478

CITY OF HOUSTON
DEPARTMENT OF PUBLIC WORKS AND ENGINEERING

WATER	WASTEWATER	TRAFFIC
ST. & BRIDGE	STORMWATER	SWU
FILE NO.: 225PP2	CITY DWG NO.:	
DRAWING SCALE:		
VERT: 1"=2'		
HORIZ: 1"=30'		
SHEET:		
5 OF 10		