

- LEGEND
 C CONCRETE
 CLR CENTERLINE OF ROAD
 DG DOWN GUY
 G GUTTER
 GB GRADE BREAK
 GP GATE POST
 LP LIGHT POLE
 NG NATURAL GROUND
 PP POWER POLE
 TC TOP OF CURB
 SN SIGN
 WV WATER VALVE

BENCH MARK

BENCH MARK: NATIONAL GEODETIC SURVEY MARKER
 Y1216, 1973 ADJ., ELEV. = 125.944
 Y1216, 1978 ADJ., ELEV. = 125.406
 Y1216, 1988 ADJ., ELEV. = 123.94 (THIS ADJUSTMENT WAS USED FOR CUTTEN ROAD)
 ELEVATIONS SHOWN HEREON ARE BASED ON 1973 ADJUSTMENT
 TBM #1: SET RAILROAD SPIKE ON SOUTH SIDE OF 14" TALLOW APPROXIMATELY 31 FEET NORTH OF THE END OF CENTERFIELD DRIVE ELEVATION = 128.60
 TBM #2: SET RAILROAD SPIKE ON SOUTH SIDE OF POWER POLE WITH TRANSFORMER ON WEST SIDE OF PRIVATE ROAD AND 200 FEET NORTH OF PRIVATE ROAD ELEVATION = 130.62
 TBM #3: SET RAILROAD SPIKE ON EAST SIDE OF POWER POLE ON WEST SIDE OF HARGRAVE ROAD AND NORTH OF THE INTERSECTION OF DOTSON ROAD & HARGRAVE ROAD ELEVATION = 128.04
 TBM #4: RAILROAD SPIKE ON EAST SIDE OF POWER POLE #13629 ON THE WEST SIDE OF HARGRAVE ROAD APPROXIMATELY 30 FEET NORTH OF 18 INCH R.C.P. AT GRAVEL DRIVE FROM 13627 HARGRAVE ROAD ELEVATION = 130.56

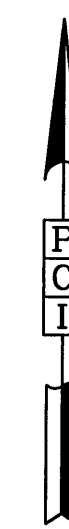
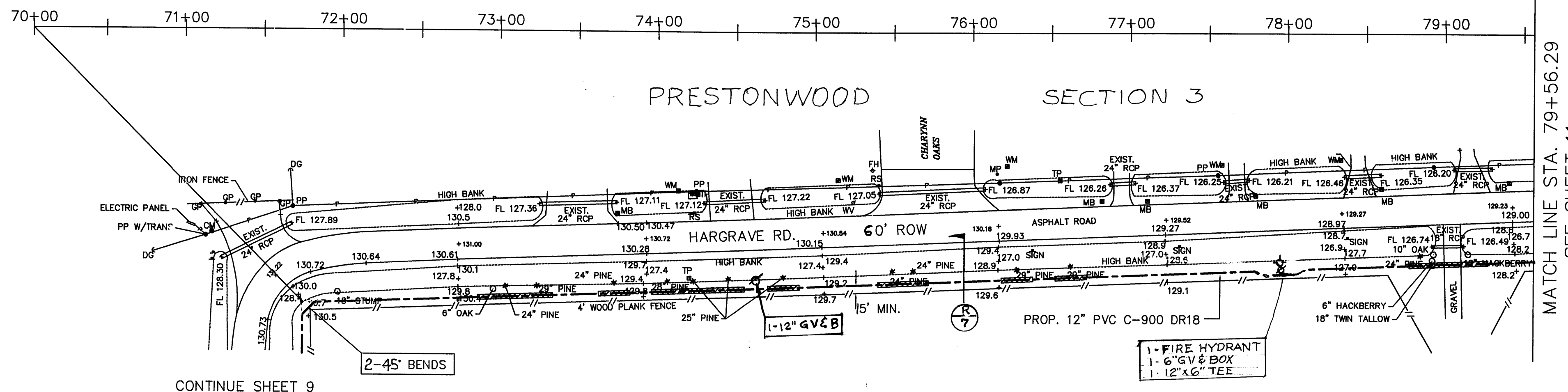

MATCH LINE STA. 79+56.29
 SEE SHEET 11

APPROVED: _____
 for Assistant County Engineer
 Date _____

Approval Implied for paving and drainage facilities within Harris County R.O.W. and/or jurisdiction. All other improvements in H.C.R.O.W. and/or jurisdiction are approved as to location only. The above authorization is valid for one (1) year only.

TREE PRESERVATION NOTES:

- NO OPEN CUT WITHIN 10' OF A TREE.
- BORE AND JACK FORCE MAIN FROM DRIP LINE TO DRIP LINE OR A MAXIMUM OF 20' AT EACH TREE UNLESS OTHERWISE SHOWN.
- OFFSET BORE 5' MINIMUM FROM ANY PINE TREE TRUNK TO AVOID BREAKING TAPROOT.

HARGRAVE ROAD (SOUTH PROFILE)

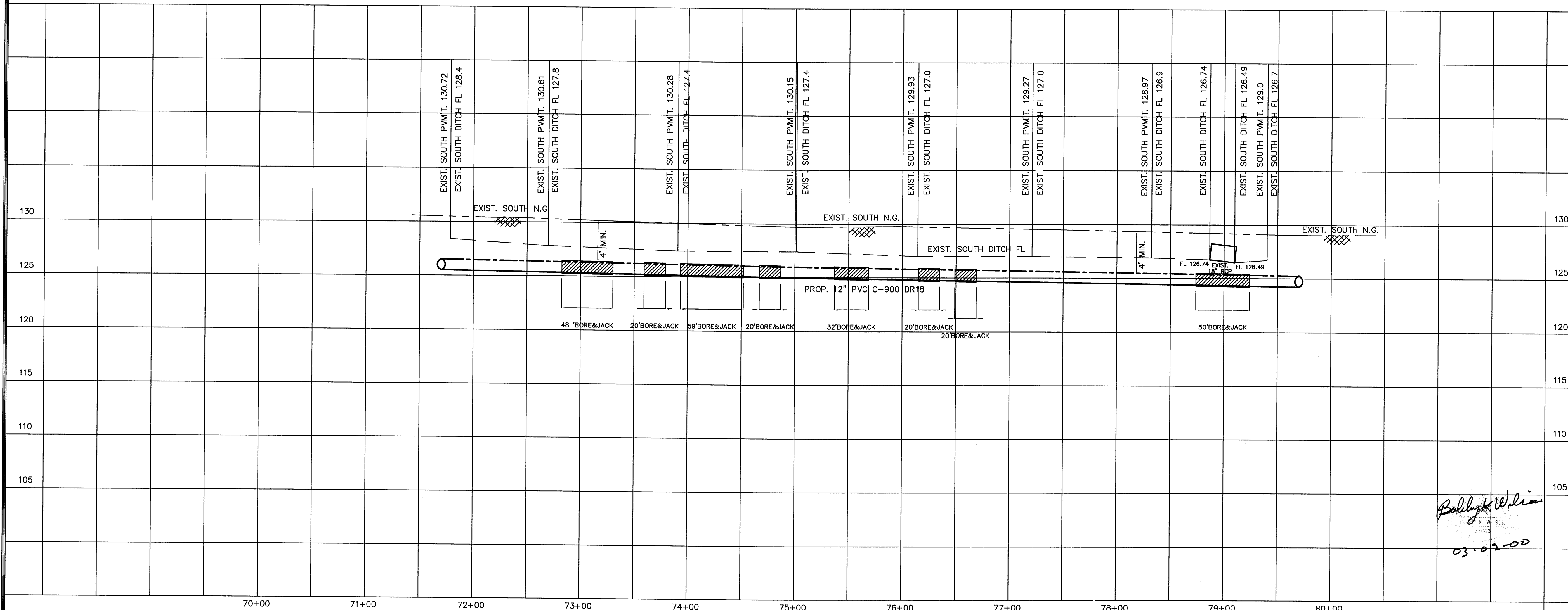

Rev.	Date	Description	App.

PRIVATE UTILITY LINES SHOWN

John H. List 3/1/2000
 REGANT ENERGIES, INC./EMERX
Kibe Balin 3/7/00
 SOUTHWESTERN BELL TELEPHONE CO.
 Valid for One Year Only
John H. List - 3/1/2000
 REGANT ENERGIES, INC./MILBOP, CO.
 Approval Only for Crossing Underground
 Ductlines Unless Noted. Valid at Time of Review Only.

CITY OF HOUSTON
 DEPARTMENT OF PUBLIC WORKS AND ENGINEERING

REVIEWED BY
 PRIVATELY FUNDED PUBLIC WORKS
 CITY FUNDED PUBLIC WORKS
Victor Saldivar 3-7-00
 WATER
Med 3-2-00
 WASTEWATER
Lawrence 3-2-00
 STORM WATER
 STREET AND BRIDGE
 PROJECT MANAGER
 CONSTRUCTION
 CHIEF ENGINEER

OTHER APPROVAL
 TRAFFIC AND TRANSPORTATION
 SPONSOR DEPARTMENT

CITY ENGINEER
Bill Dorris 3-8-2000
 DATE
 DIRECTOR OF PUBLIC WORKS AND ENGINEERING
 DATE

SUBMITTED: _____
 SCALE: H: 1"=50'
 V: 1"=5'
 DATE: MARCH 2000
 SURVEY BY: _____
 F B NO: 462U
 DESIGNED BY: B K WILSON
 DRAWN BY: BILL DORRIS
 SHEET NO. 10 OF 14 SHEETS
 CITY DWG. NO. HARDITCS.DWG

HARRIS COUNTY MUD 191
 WATER LINE ALONG
 HARGRAVE ROAD
 (SOUTH PROFILE)
 STA. 70+00 TO STA. 79+56.29

PCI PROVIDENT CONSULTING, INC.
 1200 WEST 11TH ST.
 HOUSTON, TEXAS 77008
 (713)802-1019