

- LEGEND
 C CONCRETE
 CLR CENTERLINE OF ROAD
 DG DOWN GUY
 G GUTTER
 GB GRADE BREAK
 GP GATE POST
 LP LIGHT POLE
 NG NATURAL GROUND
 PP POWER POLE
 TC TOP OF CURB
 SN SIGN
 WV WATER VALVE

BENCH MARK
 BENCH MARK: NATIONAL GEODETIC SURVEY MARKER
 Y1216, 1973 ADJ., ELEV. = 125.994
 Y1216, 1973 ADJ., ELEV. = 125.408
 Y1216, 1988 ADJ., ELEV. = 123.94 (THIS ADJUSTMENT WAS USED FOR CUTTEN ROAD)
 ELEVATIONS SHOWN HEREON ARE BASED ON 1973 ADJUSTMENT
 TBM #1: SET RAILROAD SPIKE ON SOUTH SIDE OF 14" TALLOW APPROXIMATELY 31 FEET NORTH OF THE END OF CENTERFIELD DRIVE ELEVATION = 128.60
 TBM #2: SET RAILROAD SPIKE ON SOUTH SIDE OF POWER POLE WITH TRANSFORMER ON WEST SIDE OF PRIVATE ROAD AND 200 FEET NORTH OF PRIVATE ROAD ELEVATION = 130.62
 TBM #3: SET RAILROAD SPIKE ON EAST SIDE OF POWER POLE ON WEST SIDE OF HARGRAVE ROAD AND NORTH OF THE INTERSECTION OF DOTSON ROAD & HARGRAVE ROAD ELEVATION = 128.04
 TBM #4: RAILROAD SPIKE ON EAST SIDE OF POWER POLE #13629 ON THE WEST SIDE OF HARGRAVE ROAD APPROXIMATELY 30 FEET NORTH OF 18 INCH R.C.P. AT GRAVEL DRIVE FROM 13627 HARGRAVE ROAD ELEVATION = 130.56

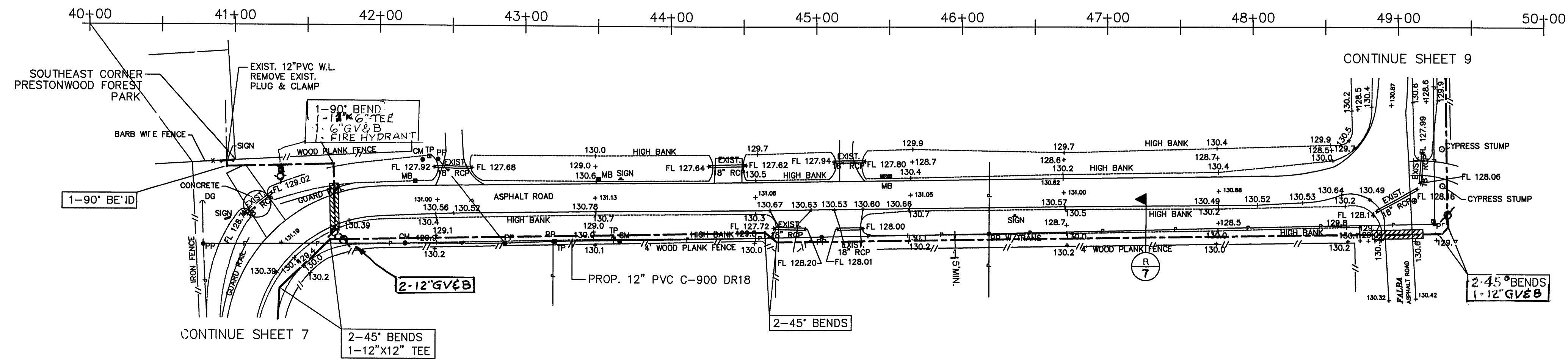

HARGRAVE ROAD (SOUTH PROFILE)

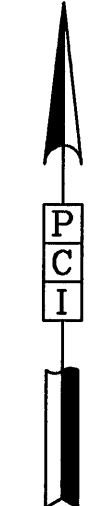
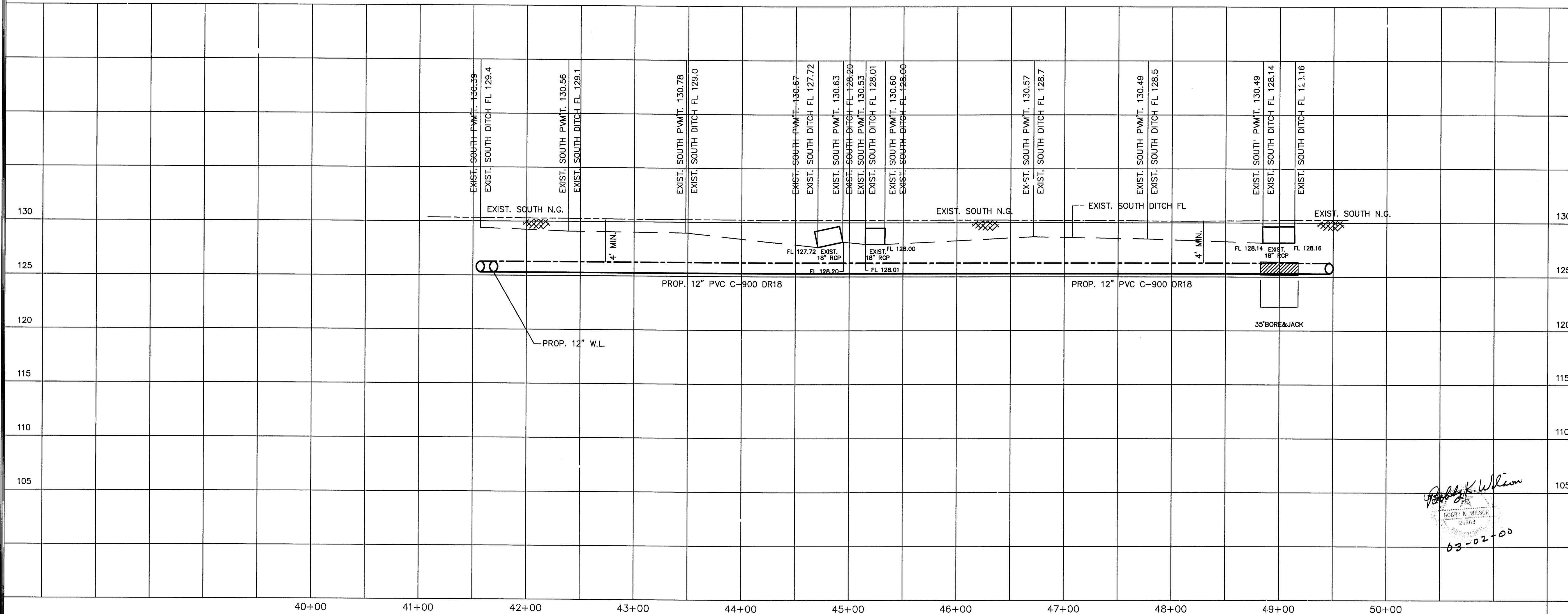

APPROVED: _____
 for Assistant County Engineer
 Date _____

Approval implied for paving and drainage facilities within Harris County R.O.W. and/or Jurisdiction. All other improvements in H.C.R.O.W. and/or Jurisdiction are approved as to location only. The above authorization is valid for one (1) year only.

Rev.	Date	Description	App.

PRIVATE UTILITY LINES SHOWN

John Lee - 3/1/2000
 RELIANT ENERGIES, INC./ENTER
Mike Balen 3/7/00
 SOUTHWESTERN BELL TELEPHONE CO.
 Valid for One Year Only
John Lee - 3/1/2000
 RELIANT ENERGIES, INC./H.L.A. CO.
 Approval Only for Crossing Underground
 Ductlines Unless Noted. Valid at Time of Review Only.

CITY OF HOUSTON
 DEPARTMENT OF PUBLIC WORKS AND ENGINEERING

REVIEWED BY
 PRIVATELY FUNDED PUBLIC WORKS CITY FUNDED PUBLIC WORKS
Victor Labadie 3-7-00
Will
 3-2-00
 PROJECT MANAGER
 WASTEWATER
 STORM WATER
Samuel 3/2/00
 CONSTRUCTION
 STREET AND BRIDGE
 CHIEF ENGINEER

OTHER APPROVAL
 TRAFFIC AND TRANSPORTATION SPONSOR DEPARTMENT

CITY ENGINEER DATE
Michael 3-8-2000
 DIRECTOR OF PUBLIC WORKS AND ENGINEERING DATE

SUBMITTED: _____ H: 1"=50'
 SCALE: _____ V: 1"=5'
 DATE: MARCH 2000
 SURVEY BY: _____ SHEET NO. 8 OF 14 SHEETS
 F B NO: 482U CITY DWG. NO. HARDITC3.DWG

HARRIS COUNTY MUD 191
 WATER LINE ALONG
 HARGRAVE ROAD
 (SOUTH PROFILE)
 STA. 40+00 TO STA. 50+00