

CONCRETE PAVEMENT CURB & GUTTER SECTION
PARBOLIC CROWN IS AN ACCEPTABLE OPTION
N.T.S.

NOTE:
PAVEMENT SECTIONS TO BE LOCATED IN CENTER OF R-0-W

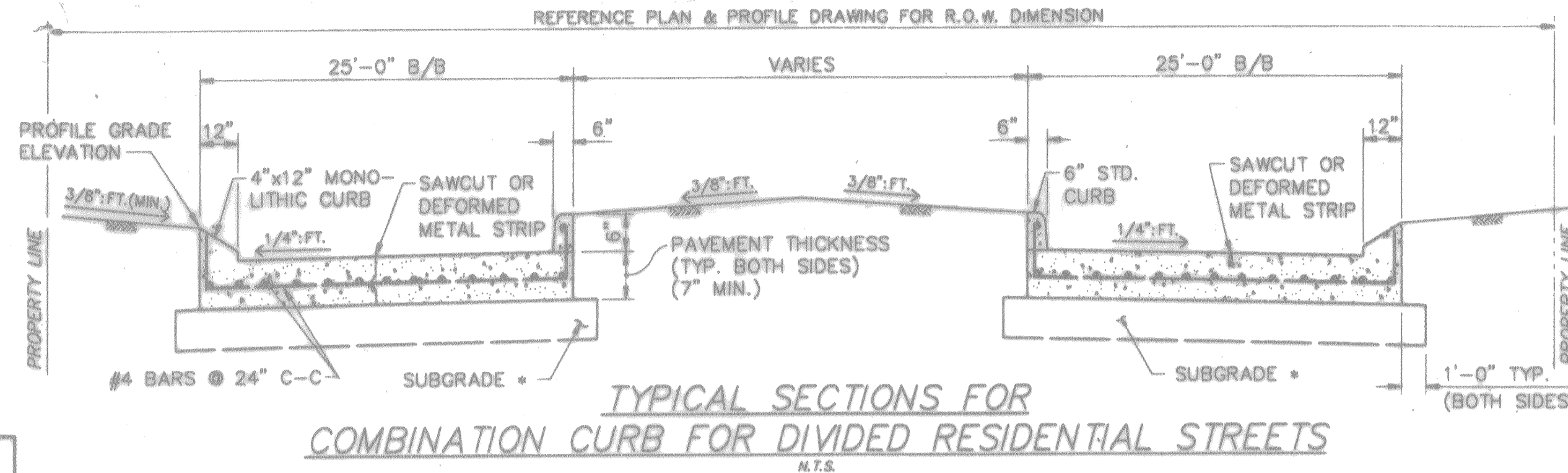

TYPICAL SECTIONS FOR COMBINATION CURB FOR DIVIDED RESIDENTIAL STREETS
N.T.S.

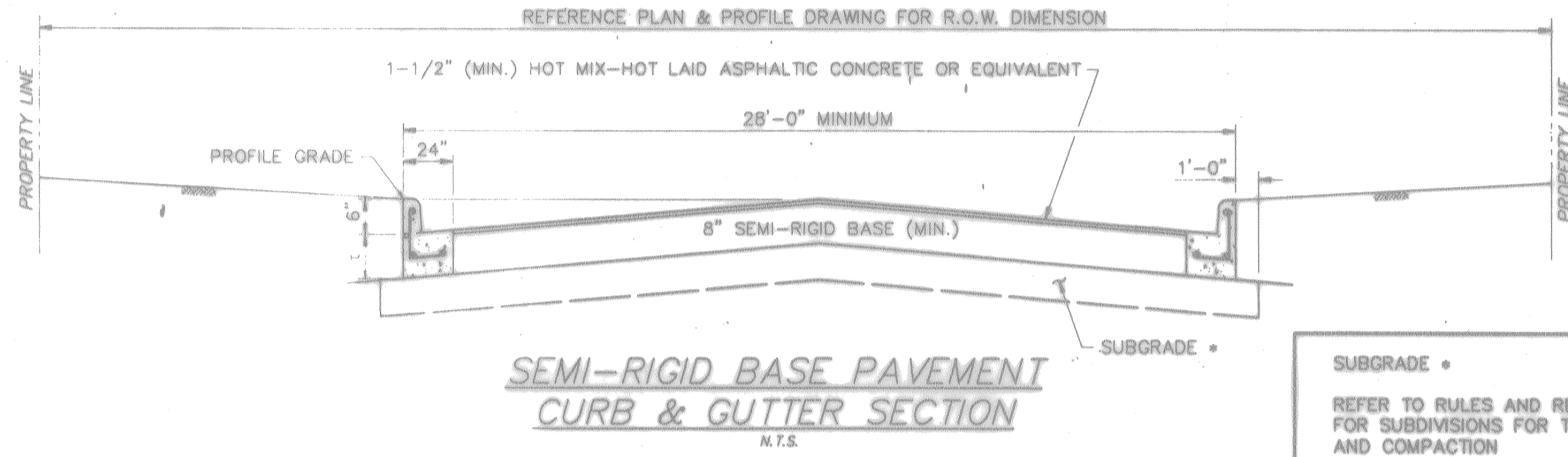

SEMI-RIGID BASE PAVEMENT CURB & GUTTER SECTION
N.T.S.

SUBGRADE •
REFER TO RULES AND REGULATIONS FOR SUBDIVISIONS FOR TREATMENT AND COMPACTION

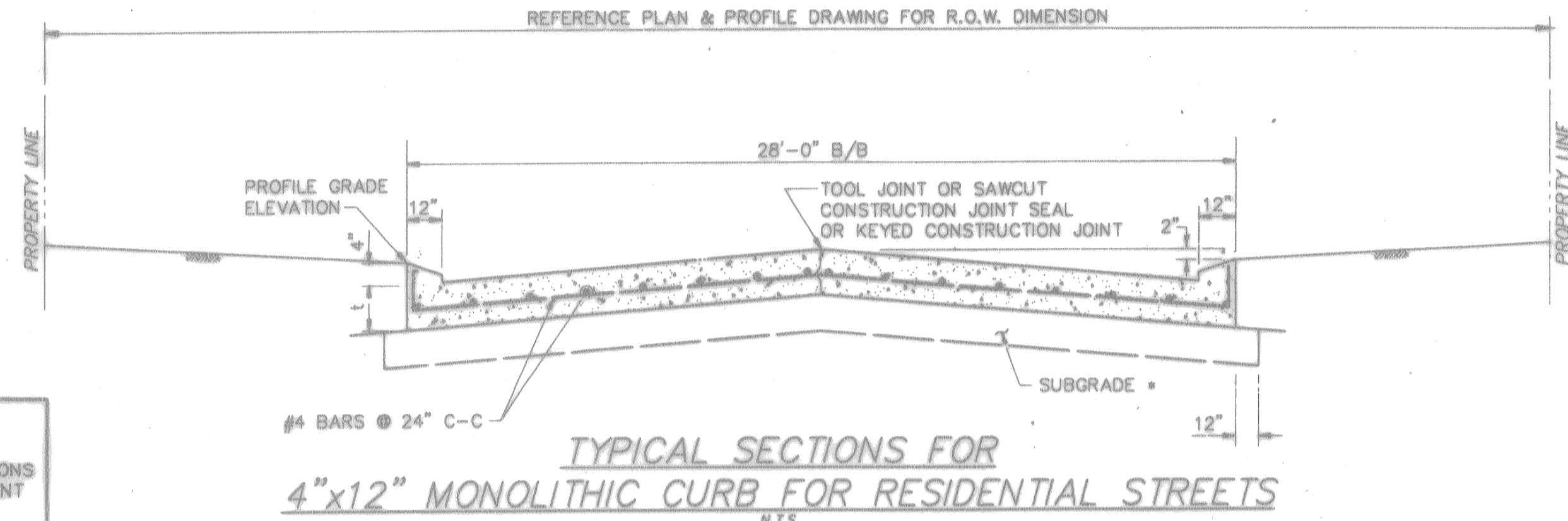

TYPICAL SECTIONS FOR 4"x12" MONOLITHIC CURB FOR RESIDENTIAL STREETS
N.T.S.

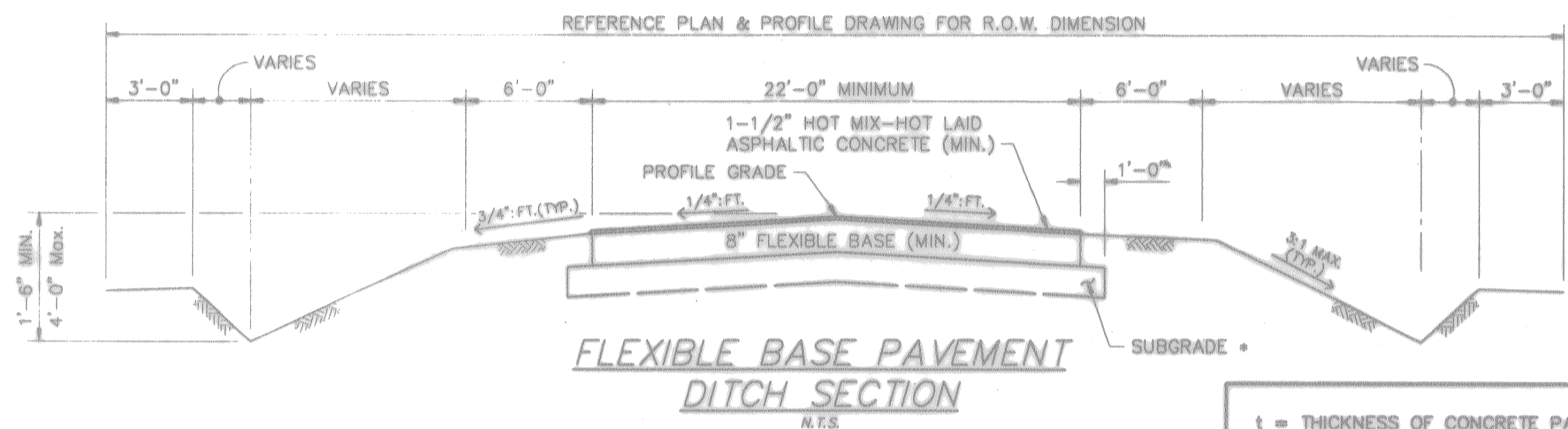

FLEXIBLE BASE PAVEMENT DITCH SECTION
N.T.S.

t = THICKNESS OF CONCRETE PAVEMENT
REFER TO SUBDIVISION RULES AND REGULATIONS

- 4"x12" MONOLITHIC AND TRANSITION CURB NOTES:**
- 6-inch concrete curb to be constructed on all esplanades, islands and non-residential streets. Residential streets may be constructed with either 6-inch concrete curb or 4-inch x 12-inch concrete curb as noted on plans.
 - All 4-inch x 12-inch concrete curbs to be poured monolithically with proposed concrete pavement.
 - Transitions from 6-inch concrete curb to 4-inch x 12-inch concrete curb to be accomplished within 10 feet, unless otherwise shown. If this 10-foot transition curb is not poured monolithically with the pavement, then reinforcing steel as shown above in typical detail 4-inch x 12-inch transition curb is to be installed.

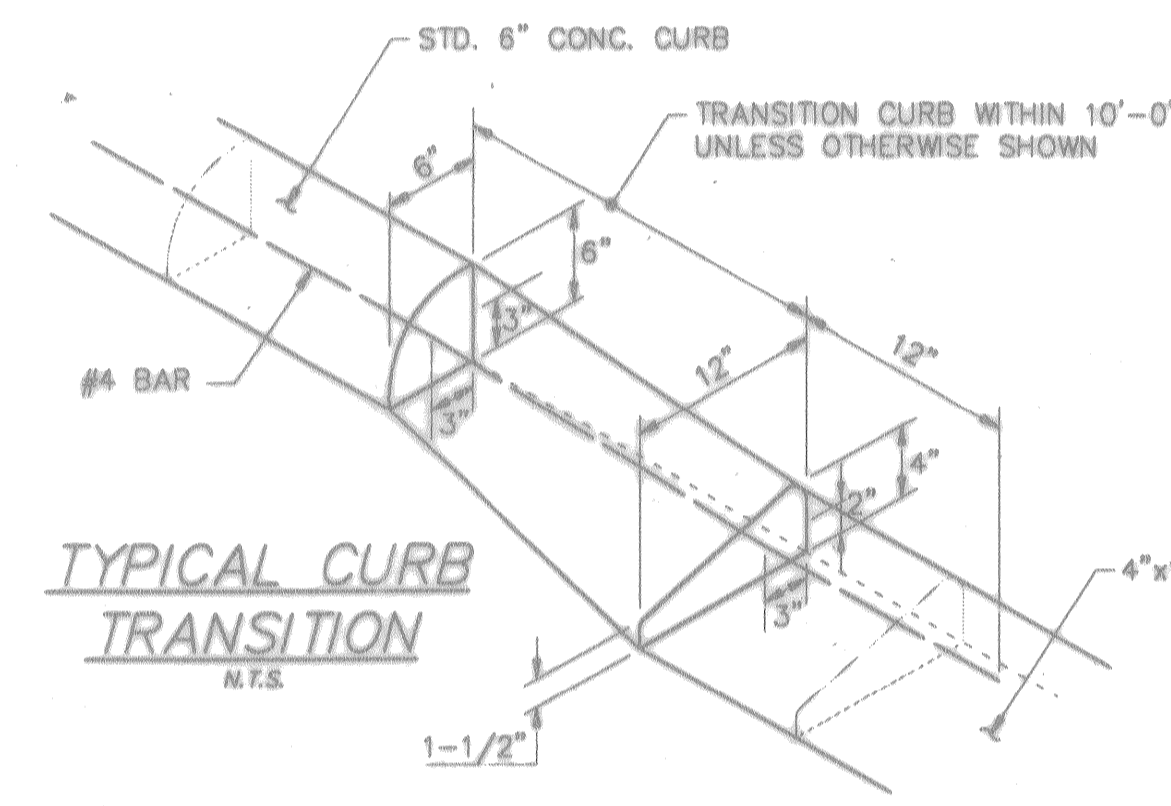

TYPICAL CURB TRANSITION
N.T.S.

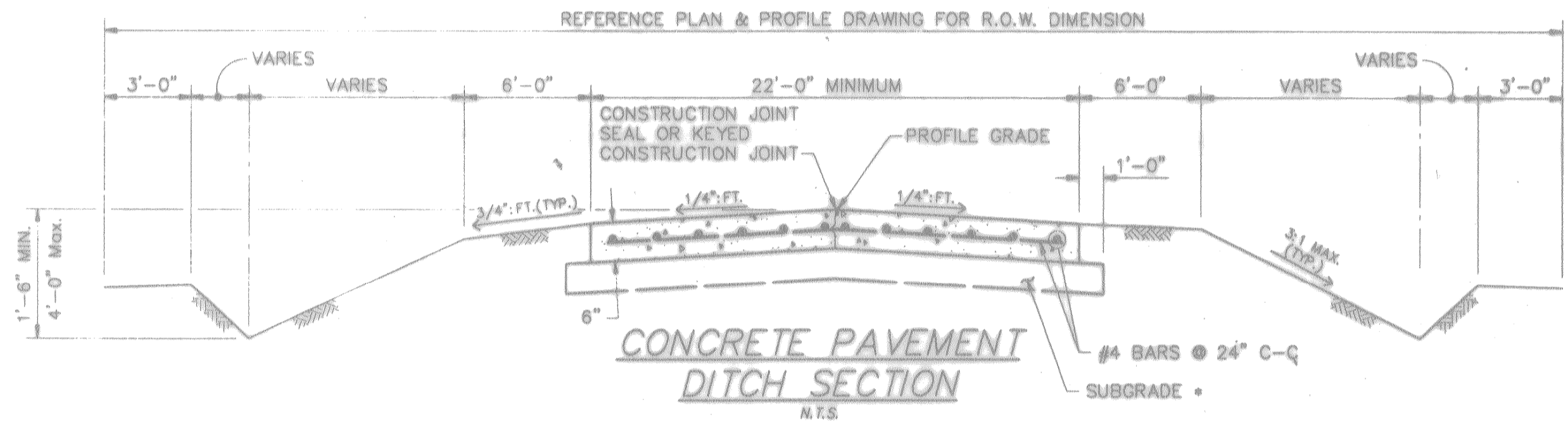

CONCRETE PAVEMENT DITCH SECTION
N.T.S.

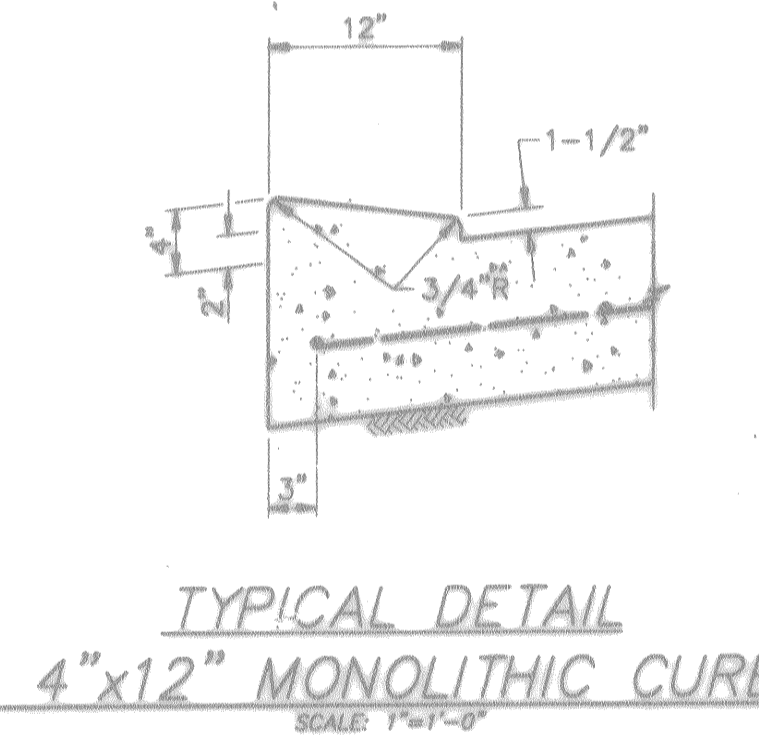

TYPICAL DETAIL 4"x12" MONOLITHIC CURB
SCALE: 1"=1'-0"

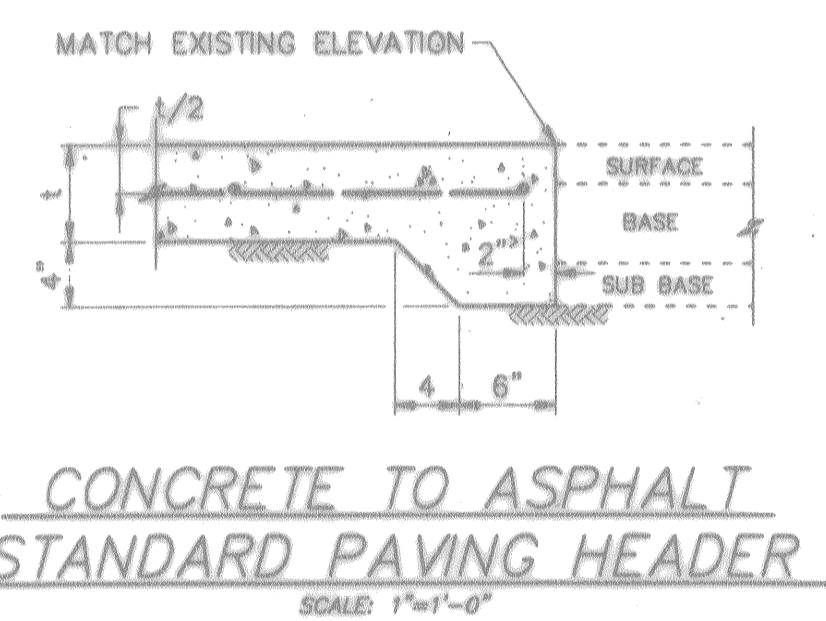

CONCRETE TO ASPHALT STANDARD PAVING HEADER
SCALE: 1"=1'-0"

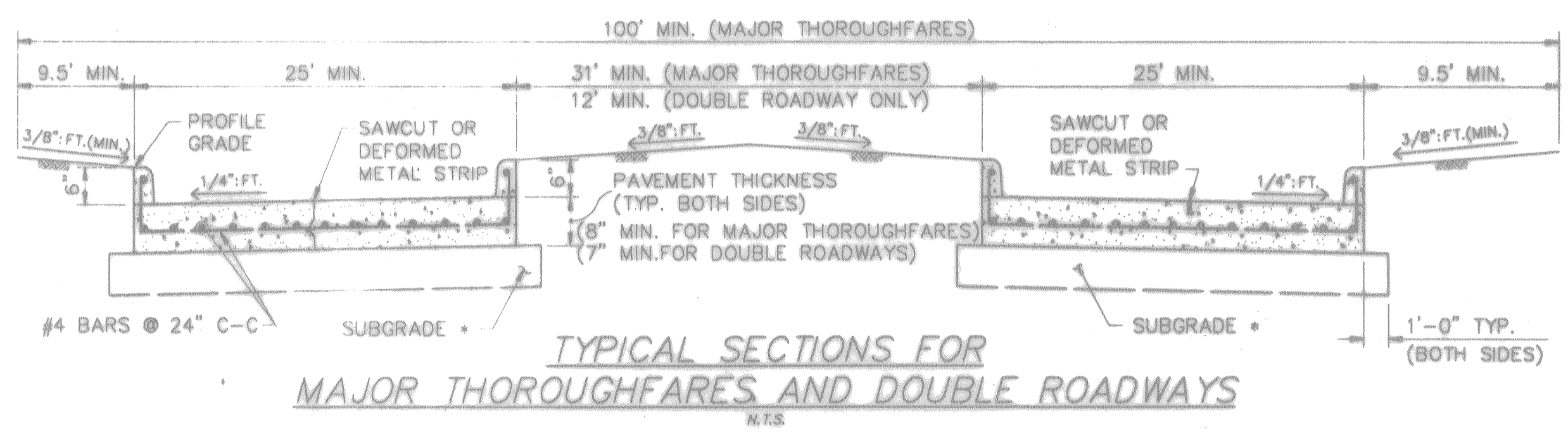

TYPICAL SECTIONS FOR MAJOR THOROUGHFARES AND DOUBLE ROADWAYS
N.T.S.

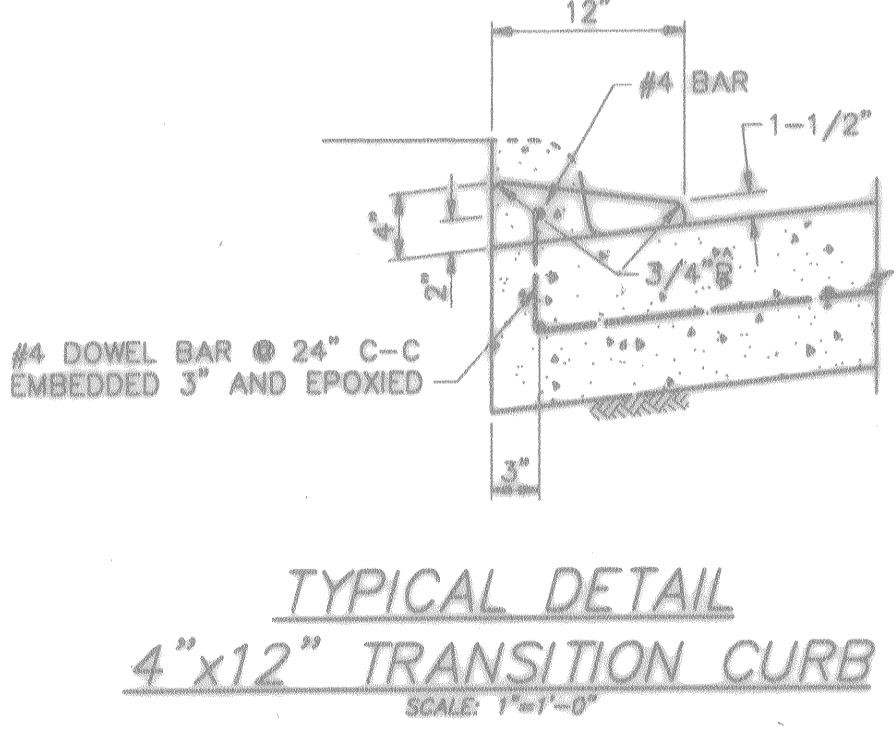

TYPICAL DETAIL 4"x12" TRANSITION CURB
SCALE: 1"=1'-0"

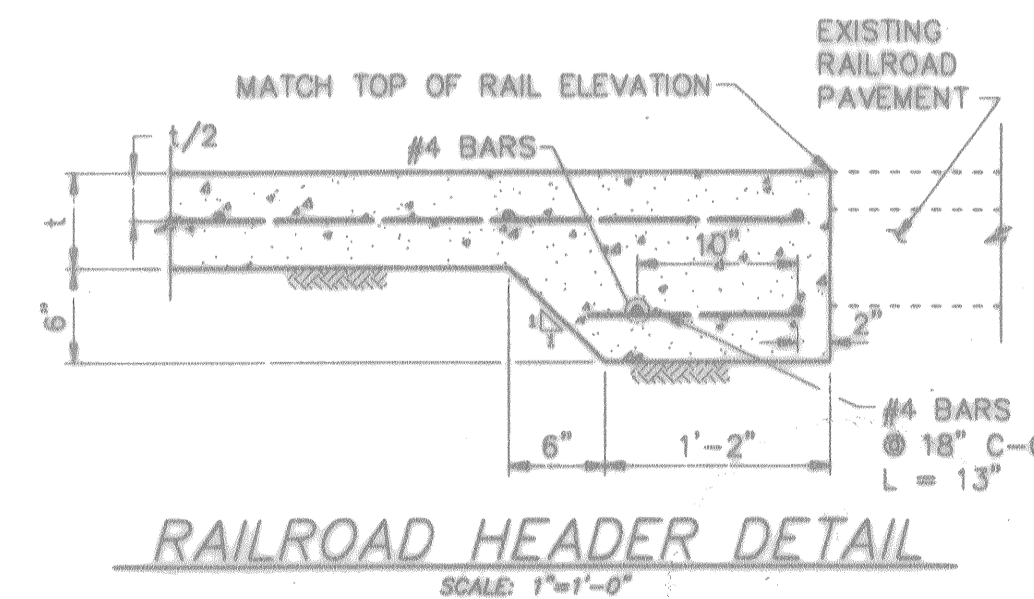

RAILROAD HEADER DETAIL
SCALE: 1"=1'-0"

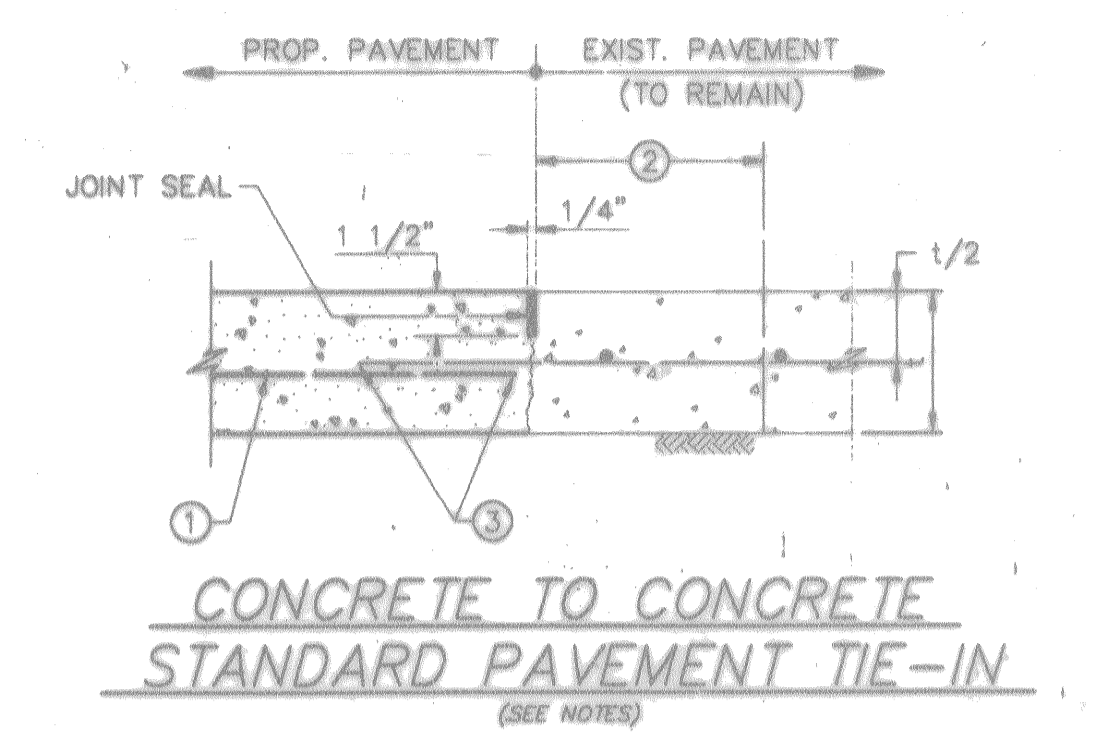

CONCRETE TO CONCRETE STANDARD PAVEMENT TIE-IN
(SEE NOTES)

- Reinforcing centered in proposed pavement, 3" clear of edges.
- Saw-cut & remove 2' existing pavement or pavement with curb. Expose and clean existing reinforcing.
- 24 bar diameter top or weld, if directed.

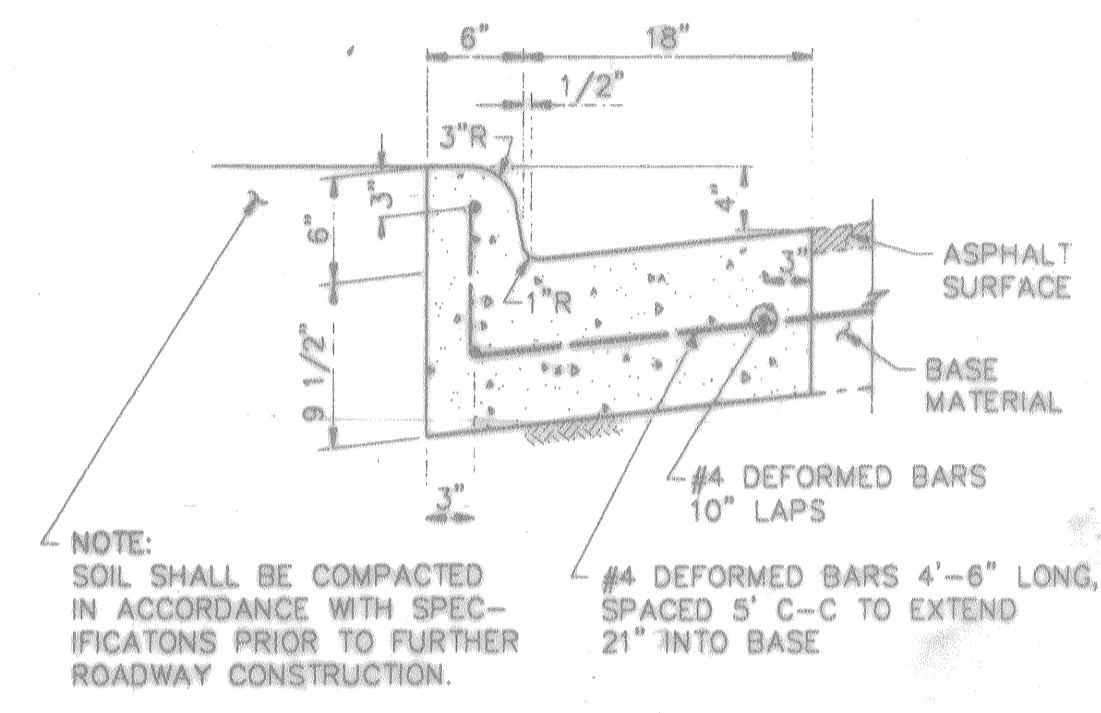

MONOLITHIC CONCRETE CURB & GUTTER DETAIL
SCALE: 1"=1'-0"

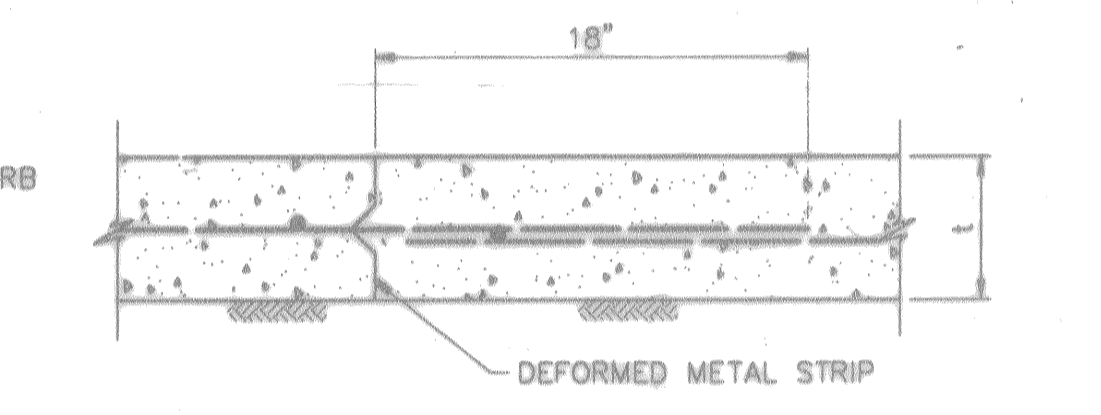

CONSTRUCTION JOINT DETAIL
SCALE: 1 1/2"=1'-0"

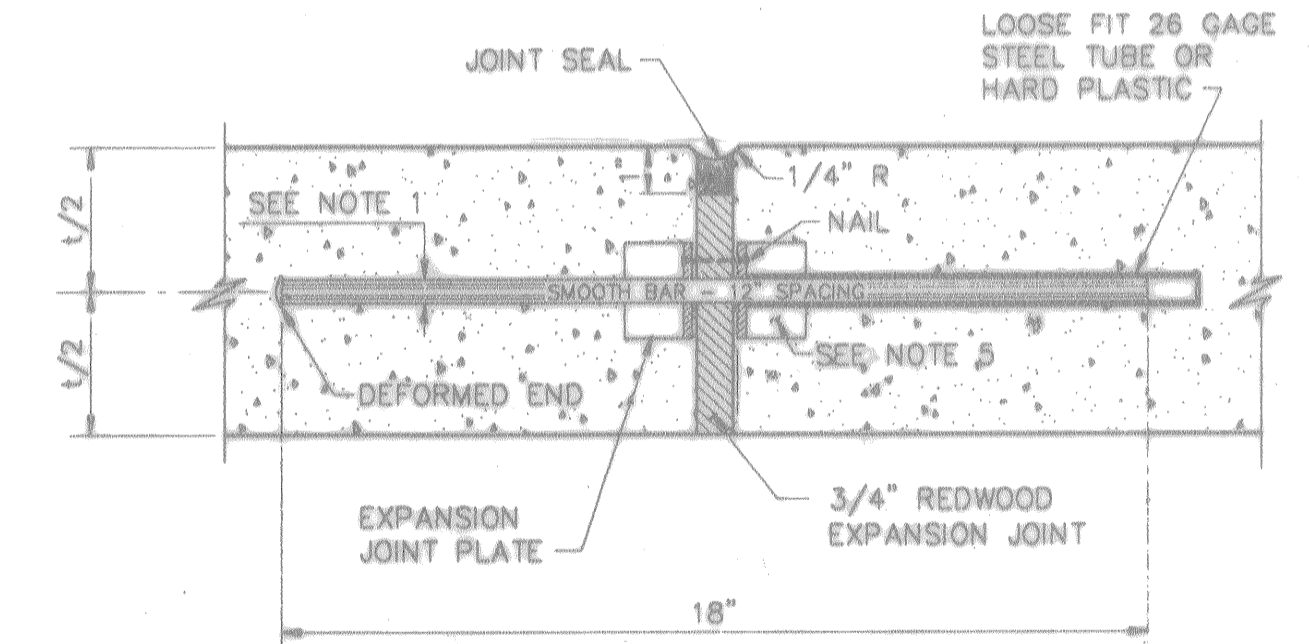

DOWEL TYPE EXPANSION JOINT DETAIL
SCALE: 3"=1'-0"

- NOTES:**
- Dowels for pavement expansion joints shall be 3/4" ø for 6" to less than 7" pavement thickness, 1" ø for 7" to less than 9" pavement thickness and 1 1/4" ø for 9" or greater pavement thickness.
 - Expansion joint shall be placed at the end of each curb return and at maximum 80' spacing (See plans).
 - All joint seal material shall be asphalt rubber in accordance with ASTM designation D3405.
 - If deformed metal strips are allowed, they shall be staked in place with #3 bars.
 - Pre-manufactured joint plate.



NO.	REVISIONS	DATE	NAME

HARRIS COUNTY ENGINEERING DEPARTMENT

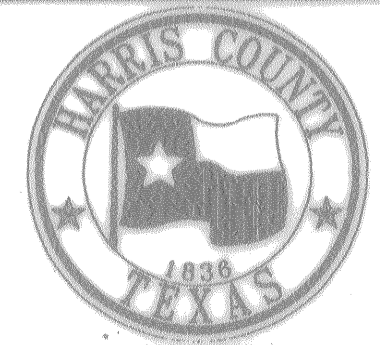

PROJECT TITLE	130414
DRAWN BY	L.M.J.
CHECKED BY	S.
SCALE	AS NOTED
DATE	09/03/93
APPROVED BY	Jerry D. Anderson
SHEET NO.	S/D-1