

BENCHMARK:
 RM192 Bronze disk set in top of concrete post, approx. 8.7 miles Southeast on Missouri-Kansas-Texas Railroad from station at Tarrant approx. 41 feet Northeast of Northeast rd. approx. 2 feet Northeast of fence, and approx. level with rail. 1973 adjustment. Elev. 130.16

NO.	DATE	REVISIONS

CONSTRUCTION PLANS
 FOR
 HARRIS COUNTY M.U.D. No. 10
PRESTONWOOD PARK SECTION 1
 HARRIS COUNTY, TEXAS

PROPOSED
 PAVING, DRAINAGE
 AND UTILITIES
 PRIVATE UTILITY LINES SHOWN

Cal National 1/19/00
 ENTEX, INC. (DATE)
Mike Balim 1/4/00
 SOUTHWESTERN BELL TELEPHONE CO. (DATE)
 VALID FOR ONE YEAR ONLY
Cal National 1/19/00
 HOUSTON LIGHTING & POWER CO. (DATE)
 APPROVAL ONLY FOR CROSSING UNDERGROUND
 DUCT LINES UNLESS NOTED. VALID AT TIME OF REVIEW ONLY

HARRIS COUNTY
 PUBLIC INFRASTRUCTURE DEPARTMENT

APPROVED: *[Signature]*
 Date

Approval implied for paving and drainage facilities within Harris County R.O.W. and/or jurisdiction. All other improvements in H.C.R.O.W. and/or jurisdiction are approved as to location only.

The above authorization is valid for one (1) year only.
CITY OF HOUSTON
 DEPARTMENT OF PUBLIC WORKS AND ENGINEERING

REVIEWED BY	CITY FUNDED PUBLIC WORKS
<i>[Signature]</i>	PROJECT MANAGER
<i>[Signature]</i>	CONSTRUCTION
<i>[Signature]</i>	CHIEF ENGINEER

OTHER APPROVAL

TRAFFIC AND TRANSPORTATION SPONSOR DEPARTMENT

CITY ENGINEER *[Signature]* 1-11-2000
 DIRECTOR OF PUBLIC WORKS AND ENGINEERING (DATE)

SUBMITTED: DESIGNED BY: S.A.J.
 SCALE: HORIZ 1" = 40' DRAWN BY: T.B.M.
 VERT 1" = 4'
 DATE: DECEMBER, 1999 SHEET NO. 20 OF 28
 SURVEY BY: JOHN THOMAS CITY DWG NO:
 F.B. NO.

SEAL

PEPE ENGINEERING 9950 CYPRESSWOOD, SUITE 500
 HOUSTON, TEXAS 77076-3411
 TELEPHONE: (281)897-0900
 pepeng@pepe-engineering.com

CADD DWG. FILE: 115_861 JOB NO.: 9817
 ORIGINAL SCALE IN INCHES FOR REDUCED PLAN

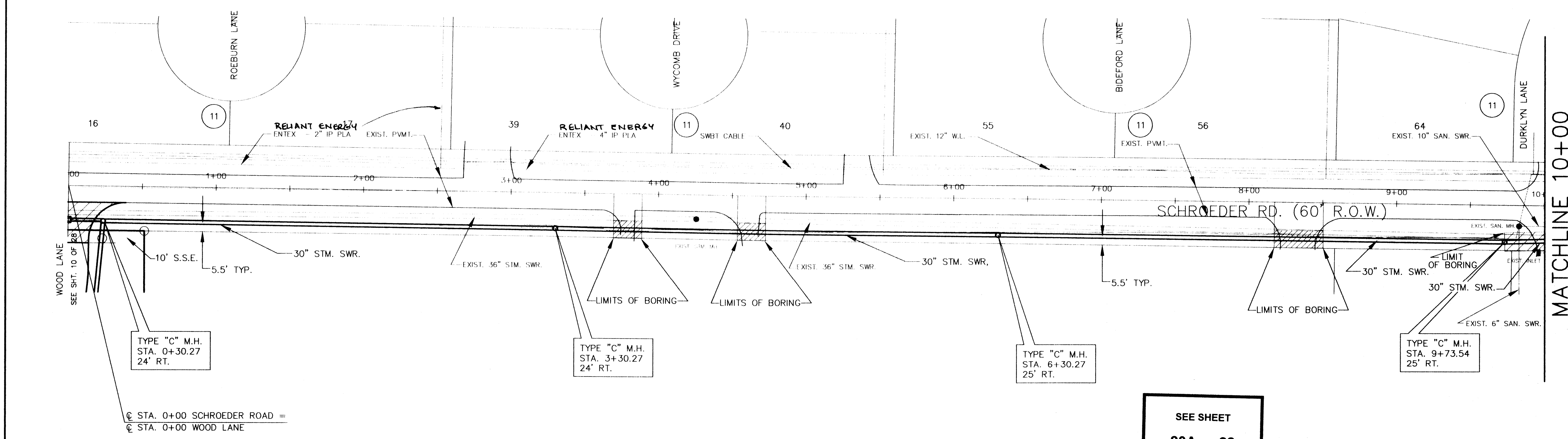

SEE SHEET 10 OF 18
 TYPE "C" M.H.
 STA. 0+30.27
 24" RT.

TYPE "C" M.H.
 STA. 3+30.27
 24" RT.

TYPE "C" M.H.
 STA. 6+30.27
 25" RT.

TYPE "C" M.H.
 STA. 9+73.54
 25" RT.

SEE SHEET
20A OF 28
 FOR
 REVISED
 STORM SEWERS

NOTES:
 1- CONTRACTOR SHALL RESTORE ALL DRIVEWAYS TO ORIGINAL OR BETTER CONDITION.
 2- CONTRACTOR SHALL RESET EXISTING CULVERTS AND RE-GRADE EAST DITCH TO EXISTING CONDITIONS.

SCHROEDER ROAD

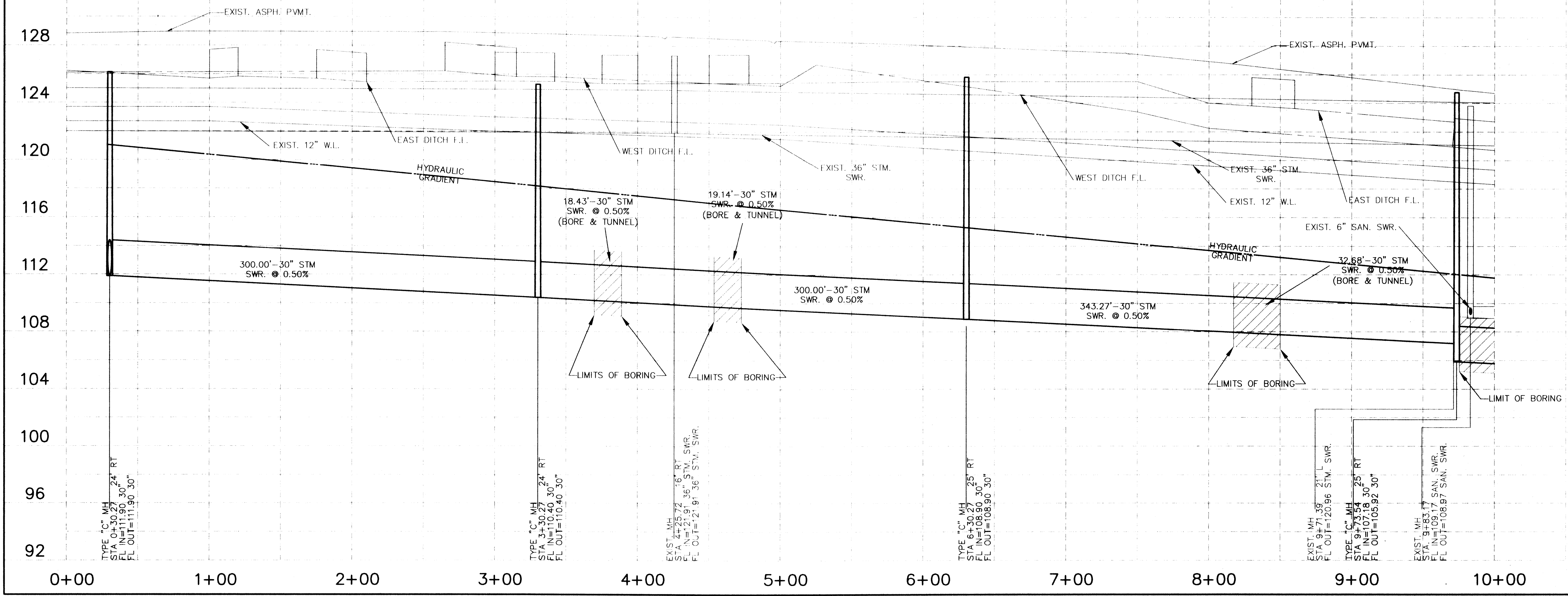

TYPE "C" M.H.
 STA. 0+30.27
 24" RT.
 FL IN=111.90
 FL OUT=111.90
 30"

TYPE "C" M.H.
 STA. 3+30.27
 24" RT.
 FL IN=110.40
 FL OUT=110.40
 30"

EXIST. M.H.
 STA. 4+21.97
 36" STM. SWR.
 FL IN=107.36
 FL OUT=107.36
 30"

TYPE "C" M.H.
 STA. 6+30.27
 25" RT.
 FL IN=108.20
 FL OUT=108.20
 30"

EXIST. M.H.
 STA. 9+71.39
 21" L.
 FL OUT=120.86
 30" SWR.

TYPE "C" M.H.
 STA. 9+73.54
 25" RT.
 FL IN=107.18
 FL OUT=107.18
 30"

EXIST. M.H.
 STA. 9+83.17
 FL IN=109.17
 FL OUT=108.87
 SAN. SWR.