

MATCHLINE 10+00

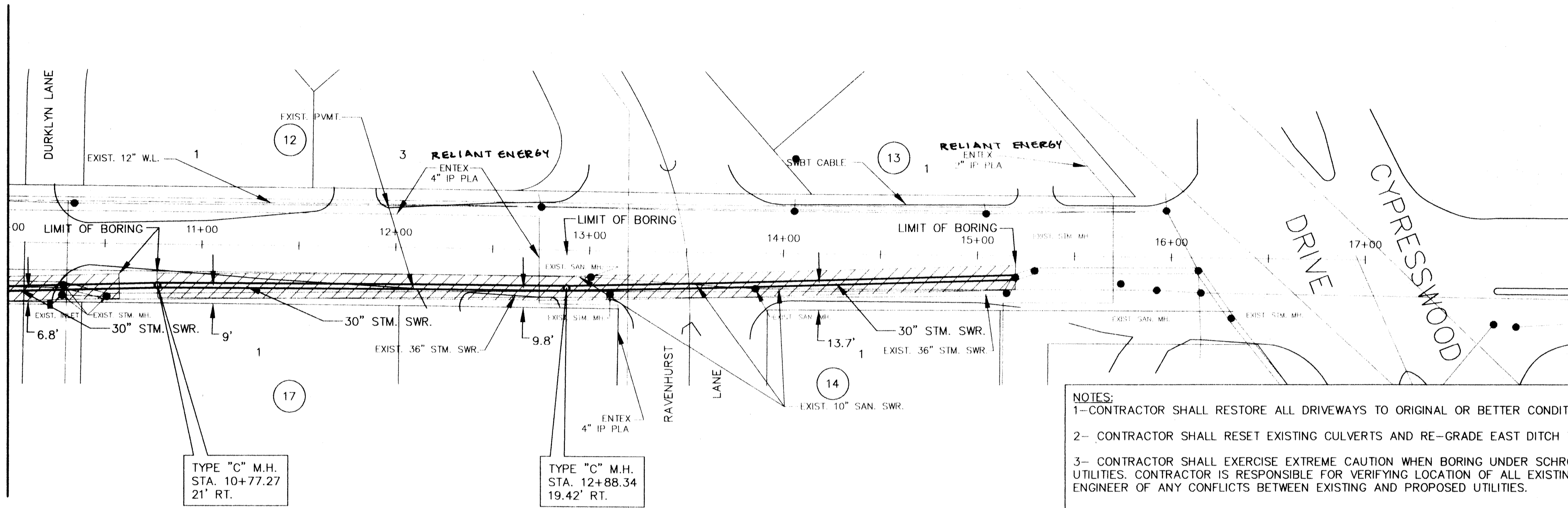

SEE SHEET  
21A OF 28  
FOR  
REVISED  
STORM SEWERS

- NOTES:
- 1- CONTRACTOR SHALL RESTORE ALL DRIVEWAYS TO ORIGINAL OR BETTER CONDITION.
  - 2- CONTRACTOR SHALL RESET EXISTING CULVERTS AND RE-GRADE EAST DITCH TO EXISTING CONDITIONS.
  - 3- CONTRACTOR SHALL EXERCISE EXTREME CAUTION WHEN BORING UNDER SCHROEDER ROAD WITH RESPECT TO EXISTING UTILITIES. CONTRACTOR IS RESPONSIBLE FOR VERIFYING LOCATION OF ALL EXISTING UTILITIES AND SHALL NOTIFY THE ENGINEER OF ANY CONFLICTS BETWEEN EXISTING AND PROPOSED UTILITIES.
  - 4- CONTRACTOR SHALL PROVIDE FOR THE ENGINEER'S REVIEW, A BORING AND TUNNELING PLAN PRIOR TO CONSTRUCTION.
  - 5- CONTRACTOR IS RESPONSIBLE FOR PROVIDING A TRAFFIC CONTROL PLAN AND FOR MAINTAINING PUBLIC SAFETY AT ALL TIMES.
  - 6- CONTRACTOR SHALL PROTECT ROADWAY FROM BEING UNDERMINED BY TRENCH EXCAVATION.
  - 7- CONTRACTOR SHALL BE RESPONSIBLE FOR REPLACING ANY FENCES OR EXISTING UTILITIES AND APPURTENANCES DAMAGED DURING CONSTRUCTION.
  - 8- CONTRACTOR SHALL BE RESPONSIBLE FOR OBTAINING ALL PERMITS REQUIRED BY HARRIS COUNTY - PERMIT DIVISION.

SCHROEDER ROAD

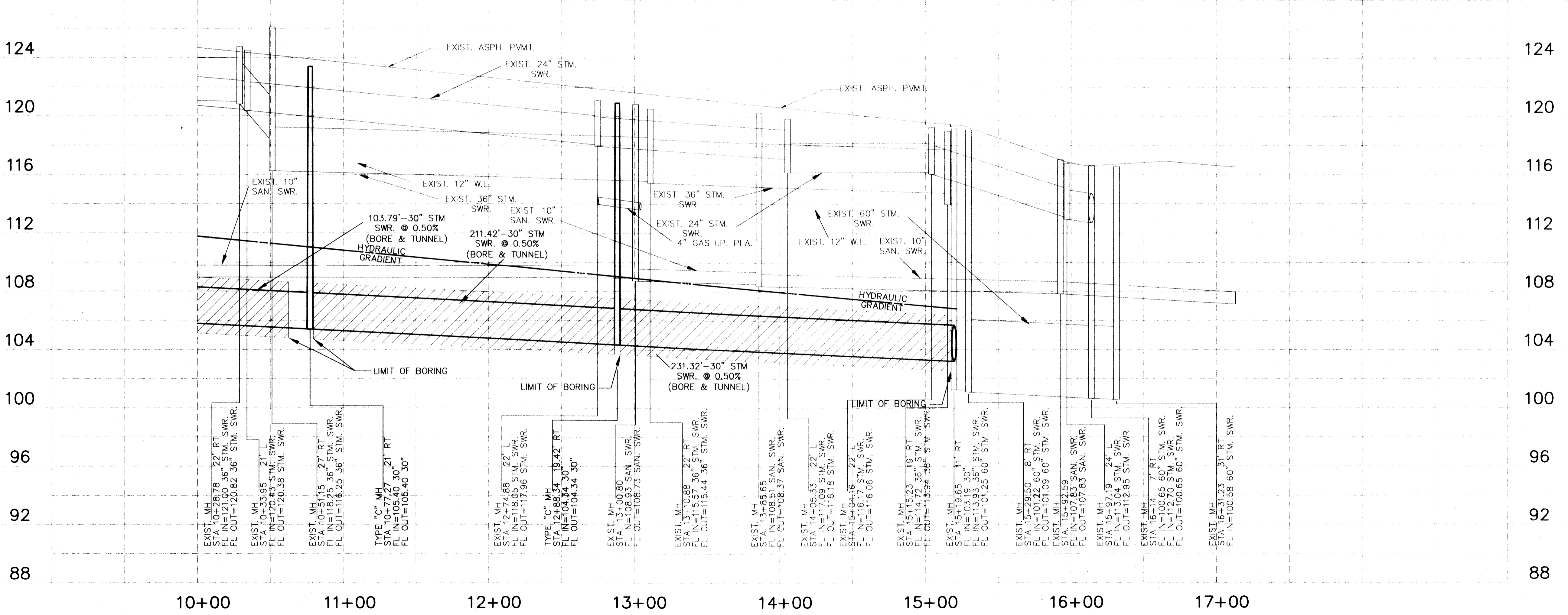

BENCHMARK  
RM192 Bronze disk set in top of concrete post, approx. 8.7 miles Southbound on Missouri, Kansas, Texas Railroad from station at 10+00 approx. 41 feet Northeast of Northeast rail, approx. 2 feet Northeast of fence, and approx. level with rail. 1973 adjustment. Elev. 150.0

NO. DATE REVISIONS

CONSTRUCTION PLANS  
FOR  
HARRIS COUNTY M.U.D. NO. 1  
PRESTONWOOD PARK  
SECTION 1  
HARRIS COUNTY, TEXAS

PROPOSED  
PAVING, DRAINAGE  
AND UTILITIES

PRIVATE UTILITY LINES SHOWN

*Cal Walcott* 1/4/00  
ENTEX, INC.  
*Mike Balin* 1/4/00  
SOUTHWESTERN BELL TELEPHONE CO.  
VALID FOR ONE YEAR ONLY  
*Cal Walcott* 1/4/00  
HOUSTON LIGHTING & POWER CO.  
APPROVAL ONLY FOR CROSSING UNDERGROUND  
DUCT LINES UNLESS NOTED. VALID AT TIME OF REVIEW.

HARRIS COUNTY  
PUBLIC INFRASTRUCTURE DEPARTMENT

APPROVED: **VOID**

Date: 1/11/00

Approval implied for paving and drainage facilities within the R.O.W. and/or jurisdiction. All other improvements in this jurisdiction are approved as to location only.

The above authorization is valid for one (1) year only.

CITY OF HOUSTON  
DEPARTMENT OF PUBLIC WORKS AND ENGINEERING

REVIEWED BY:

PRIVATELY FUNDED PUBLIC WORKS WATER <i>Victor Galvan</i> 1/11/00	CITY FUNDED PUBLIC WORKS PROJECT MANAGER <i>John Thomas</i> 1/11/00
WASTEWATER <i>John Thomas</i> 1/11/00	CONSTRUCTION CHIEF ENGINEER <i>John Thomas</i> 1/11/00
STORM WATER	CHIEF ENGINEER

OTHER APPROVAL

TRAFFIC AND TRANSPORTATION SPONSOR DEPARTMENT

CITY ENGINEER  
*John Thomas* 1-11-00  
DIRECTOR OF PUBLIC WORKS AND ENGINEERING

SUBMITTED: SCALE: HORIZ. 1" = 40'  
VERT. 1" = 4'  
DATE: DECEMBER, 1999  
SURVEY BY: JOHN THOMAS  
DESIGNED BY: S.A.J.  
DRAWN BY: E.B.M.  
SHEET NO. 21 OF 28  
CITY DWG NO.

SEAL  
*John Thomas* 1/11/00  
SALIM A. JIBR  
35568

PEPE ENGINEERING  
9950 CYPRESSWOOD, SUITE 200  
HOUSTON, TEXAS 77079  
TELEPHONE: (281) 999-1111  
pepeinc@pepe-engineering.com

CADD DWG FILE: 115\_862 JOB NO.: 9911  
ORIGINAL SCALE IN 1" = 40'  
FOR REDUCED PLAN