

BENCHMARK

RM192 Bronze disk set in top of concrete post, approx. 8.7 miles Southeast on Missouri Kansas-Texas Railroad from station at Tomball, approx. 41 feet Northeast of Northeast rail, approx. 2 feet Northeast of fence, and approx level with rail. 1973 adjustment. Elev. 130.16

NO.	DATE	REVISIONS	APP.

CONSTRUCTION PLANS
FOR
HARRIS COUNTY M.U.D. No. 19
PRESTONWOOD PARK
SECTION 1
HARRIS COUNTY, TEXAS

PROPOSED
POND LAYOUT
AND DETAILS
PRIVATE UTILITY LINES SHOWN

NA	1/19/00
ENTEX, INC.	DATE
NA	1/19/00
SOUTHWESTERN BELL TELEPHONE CO.	DATE
VALID FOR ONE YEAR ONLY	
NA	1/19/00
HOUSTON LIGHTING & POWER CO.	DATE
APPROVAL ONLY FOR CROSSING UNDERGROUND	
DUCT LINES UNLESS NOTED. VALID AT TIME OF REVIEW ONLY	

HARRIS COUNTY
PUBLIC INFRASTRUCTURE DEPARTMENT

APPROVED: _____
for Assistant County Engineer

Date
Approval implied for paving and drainage facilities within Harris County R.O.W. and/or jurisdiction. All other improvements in H.C.R.O.W. and/or jurisdiction are approved as to location only.

The above authorization is valid for one (1) year only.

CITY OF HOUSTON
DEPARTMENT OF PUBLIC WORKS AND ENGINEERING

REVIEWED BY	CITY FUNDED PUBLIC WORKS
PRIVATELY FUNDED PUBLIC WORKS	CITY FUNDED PUBLIC WORKS
WATER	WATER
WASTEWATER	WASTEWATER
STORM WATER	STORM WATER
PROJECT MANAGER	
CONSTRUCTION	
CHIEF ENGINEER	

OTHER APPROVAL

TRAFFIC AND TRANSPORTATION SPONSOR DEPARTMENT

CITY ENGINEER DATE
1-11-2000

DESIGNED BY: S.A.J.
DRAWN BY: T.B.M.
DATE: DECEMBER, 1999 SHEET NO. 7 OF 28 SHEETS
SURVEY BY: JOHN THOMAS CITY DWG NO:
F B NO:

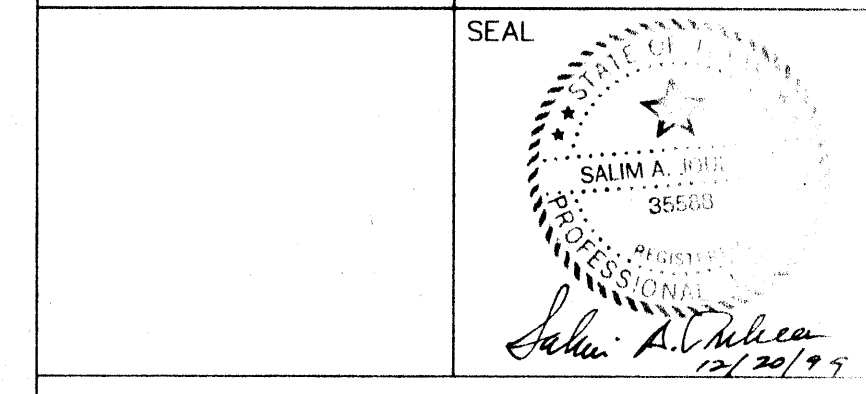

PEPE ENGINEERING
9950 CYPRESSWOOD, SUITE 300
HOUSTON, TEXAS 77070-3412
TELEPHONE: (281)887-0590
pepinc@pepe-engineering.com

CADD DWG. FILE: 115_890_ JOB NO: 9815
ORIGINAL SCALE IN INCHES FOR REDUCED PLANS

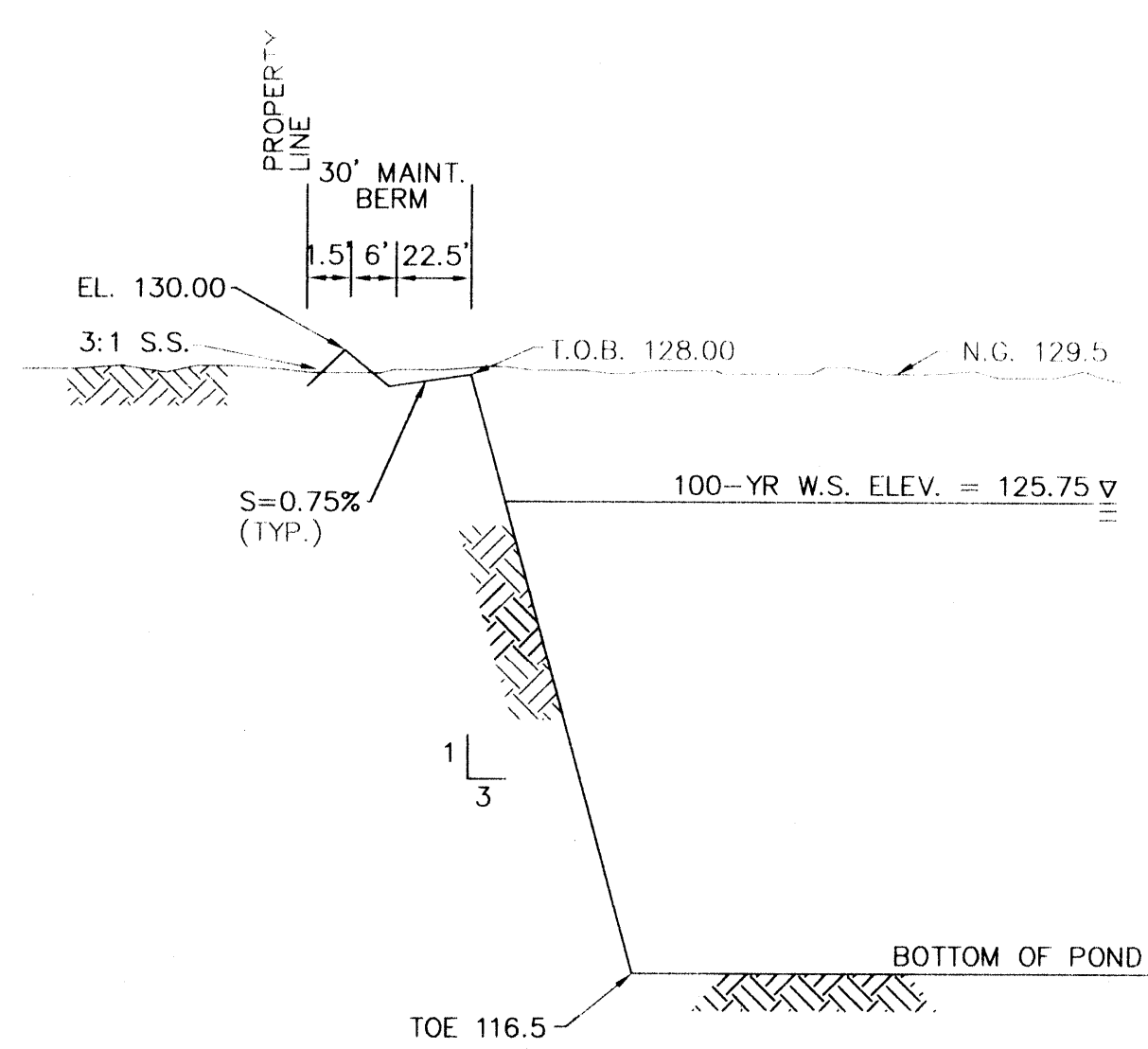

SECTION A-A
N.T.S.

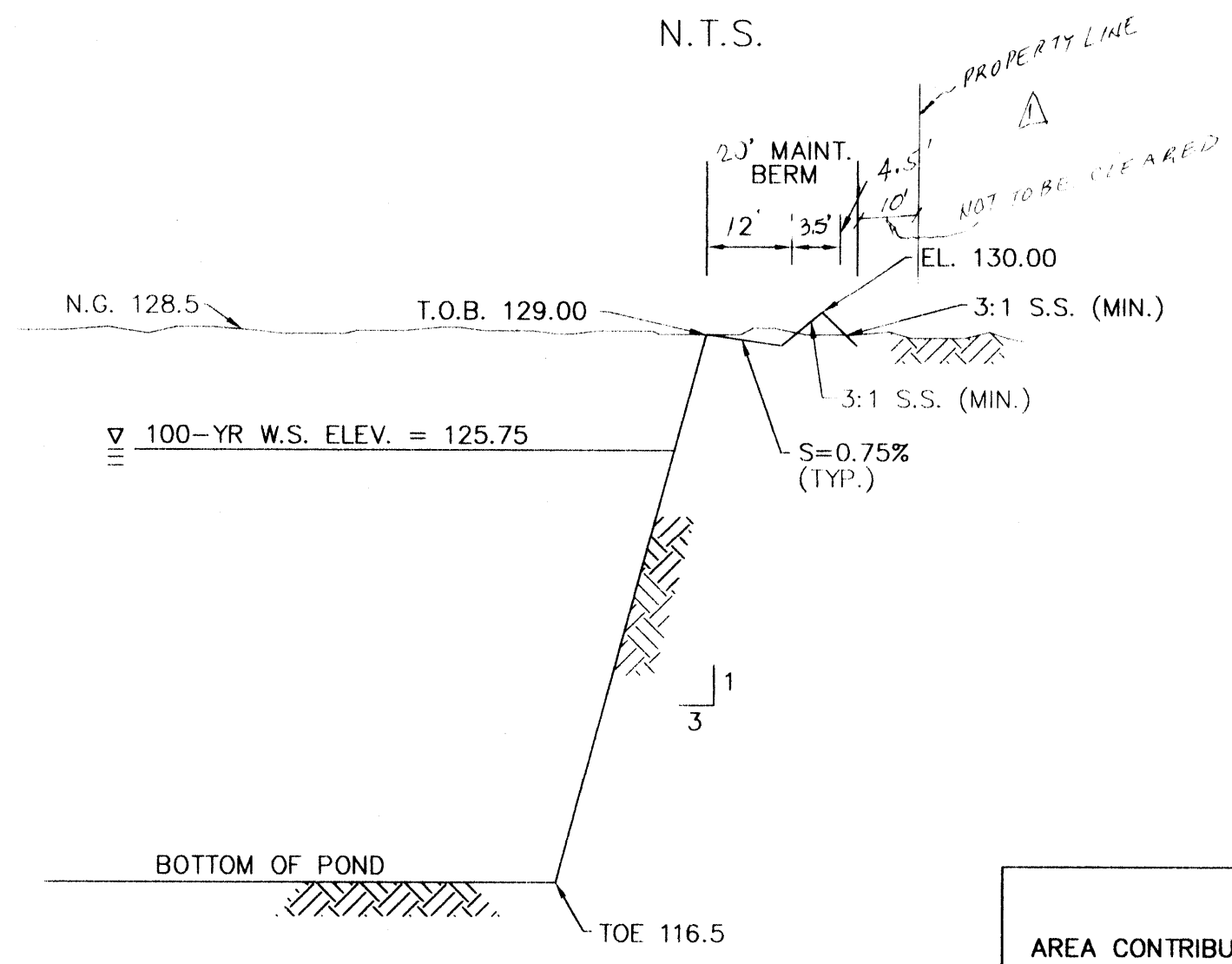

SECTION B-B
N.T.S.

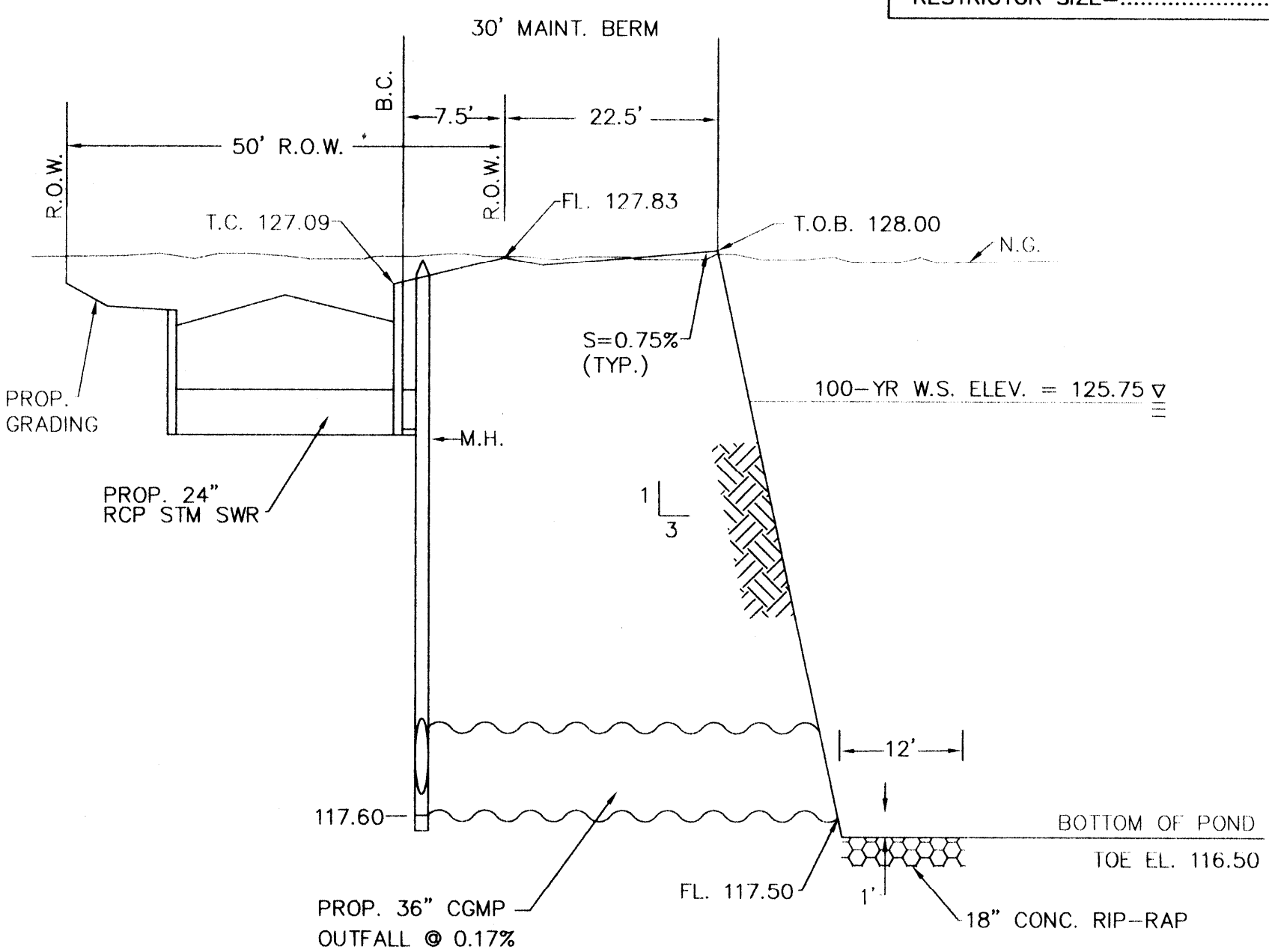

SECTION C-C
N.T.S.

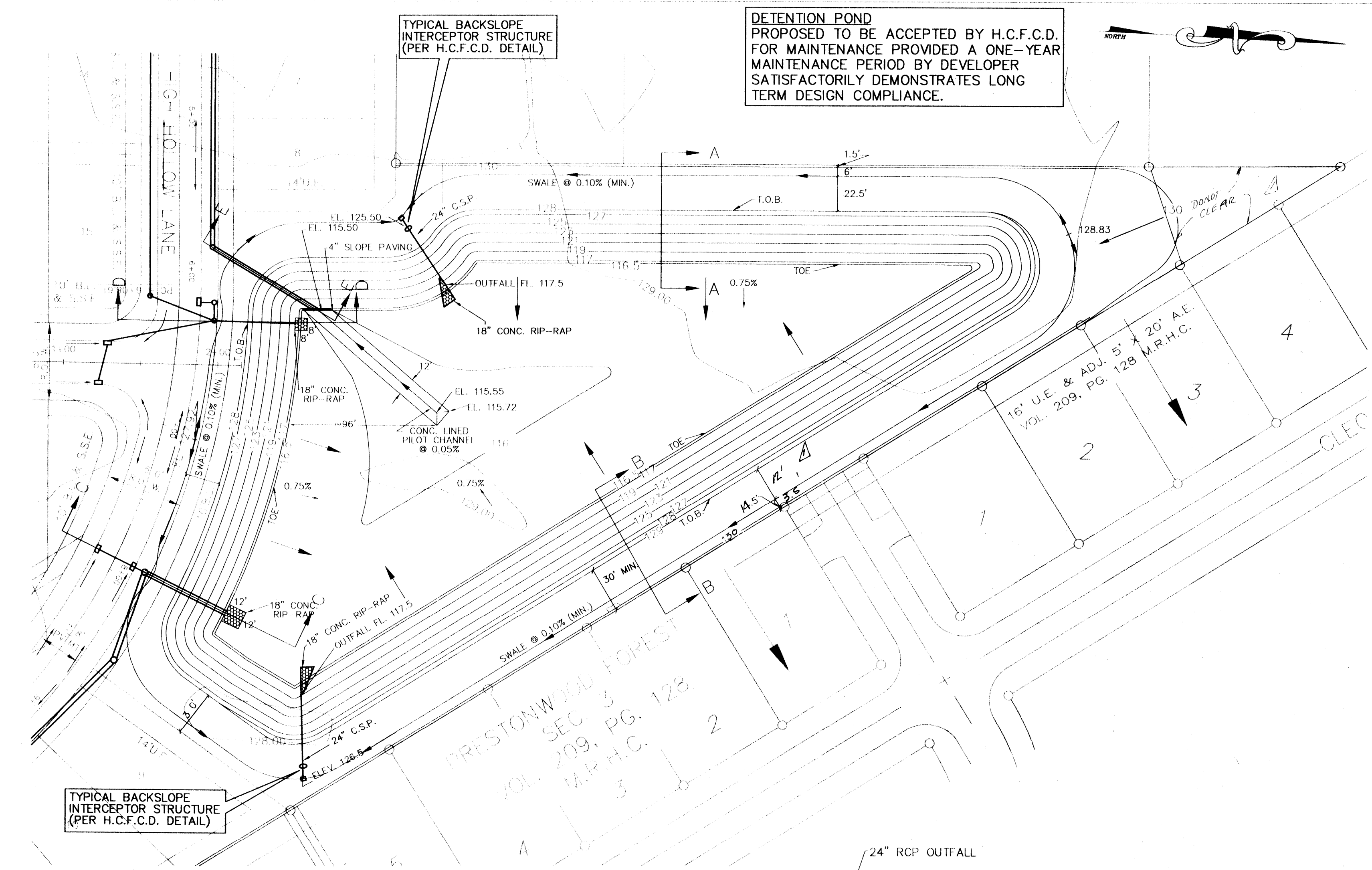

TYPICAL BACKSLOPE INTERCEPTOR STRUCTURE (PER H.C.F.C.D. DETAIL)

DETENTION POND PROPOSED TO BE ACCEPTED BY H.C.F.C.D. FOR MAINTENANCE PROVIDED A ONE-YEAR MAINTENANCE PERIOD BY DEVELOPER SATISFACTORILY DEMONSTRATES LONG TERM DESIGN COMPLIANCE.

DETENTION POND SUMMARY	
AREA CONTRIBUTING=	54.3 ACRES
AREA SERVICED=	34.9 ACRES
DETENTION STORAGE RATE =Cs=	0.51 ACRE- FEET /ACRE
DETENTION STORAGE VOLUME REQUIRED=	17.8 ACRE- FEET
DETENTION STORAGE VOLUME PROVIDED=	23.3 ACRE- FEET (AT TOP OF BANK)
MAXIMUM DESIGN WATER SURFACE ELEVATION=	125.75 (1973 ADJ.; AT REQUIRED DETENTION VOLUME)
MAXIMUM OUTFALL RATE ALLOWED=	17.45 CFS
MAXIMUM OUTFALL RATE PROVIDED=	17.45 CFS
RESTRICTOR SIZE=	24 INCHES

SCALE = 1" = 50'

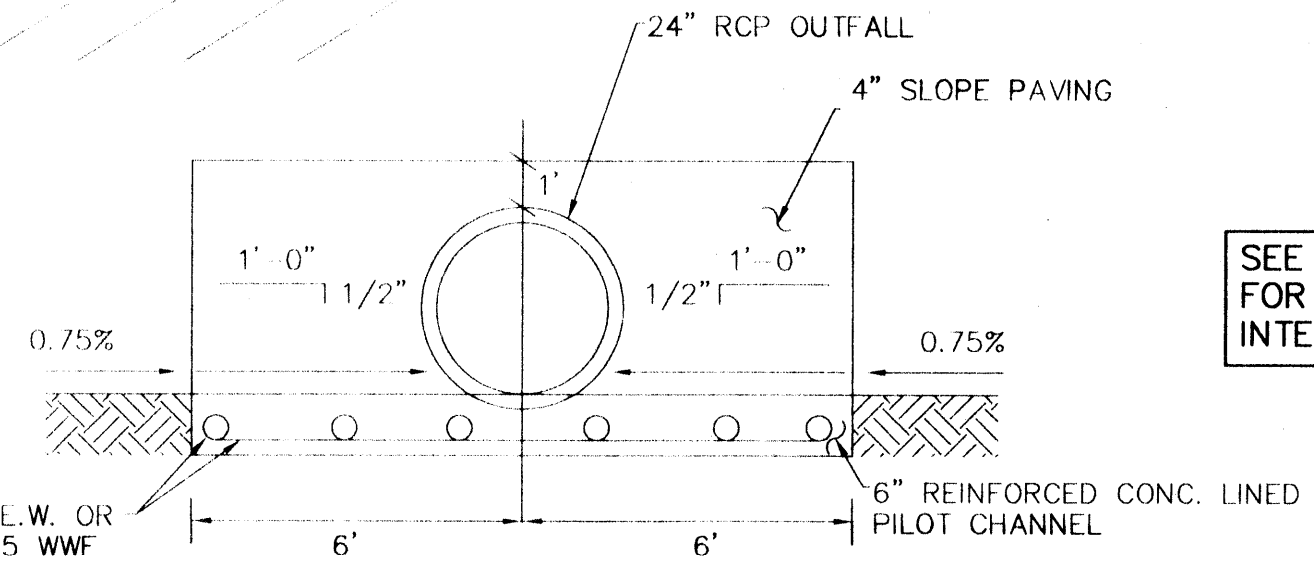

SEE SHEET 22 OF 28 FOR STANDARD HCFCD OUTFALL AND INTERCEPTOR STRUCTURE DETAIL

For Rev. Δ
INTERPOSE NO OBJECTION
FINAL APPROVAL BY OTHERS
J.A. Parker
Harris County Flood Control District
1/21/2000
Date THE ABOVE SIGNATURE VALID FOR ONE (1) YEAR ONLY.

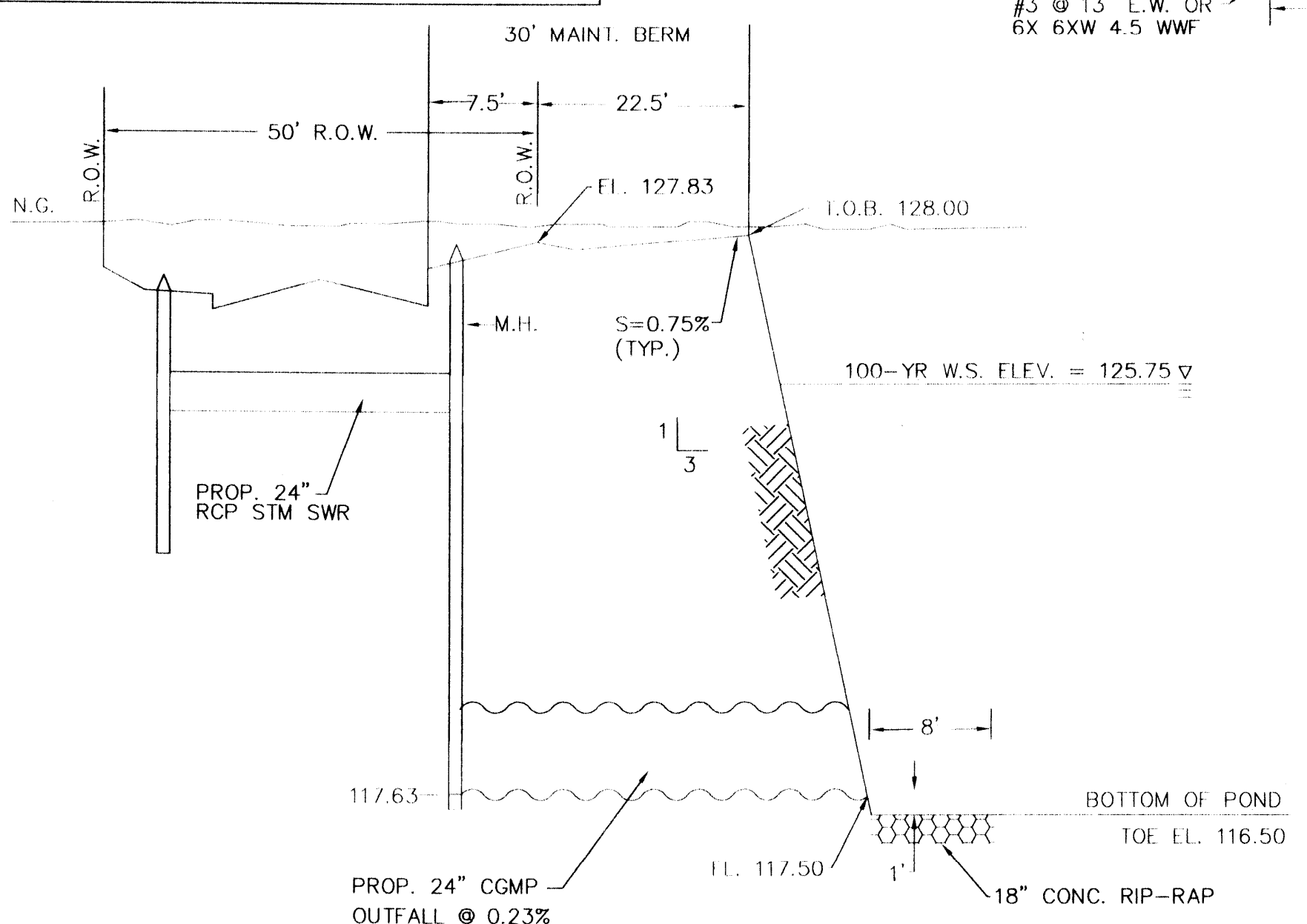

SECTION D-D
N.T.S.

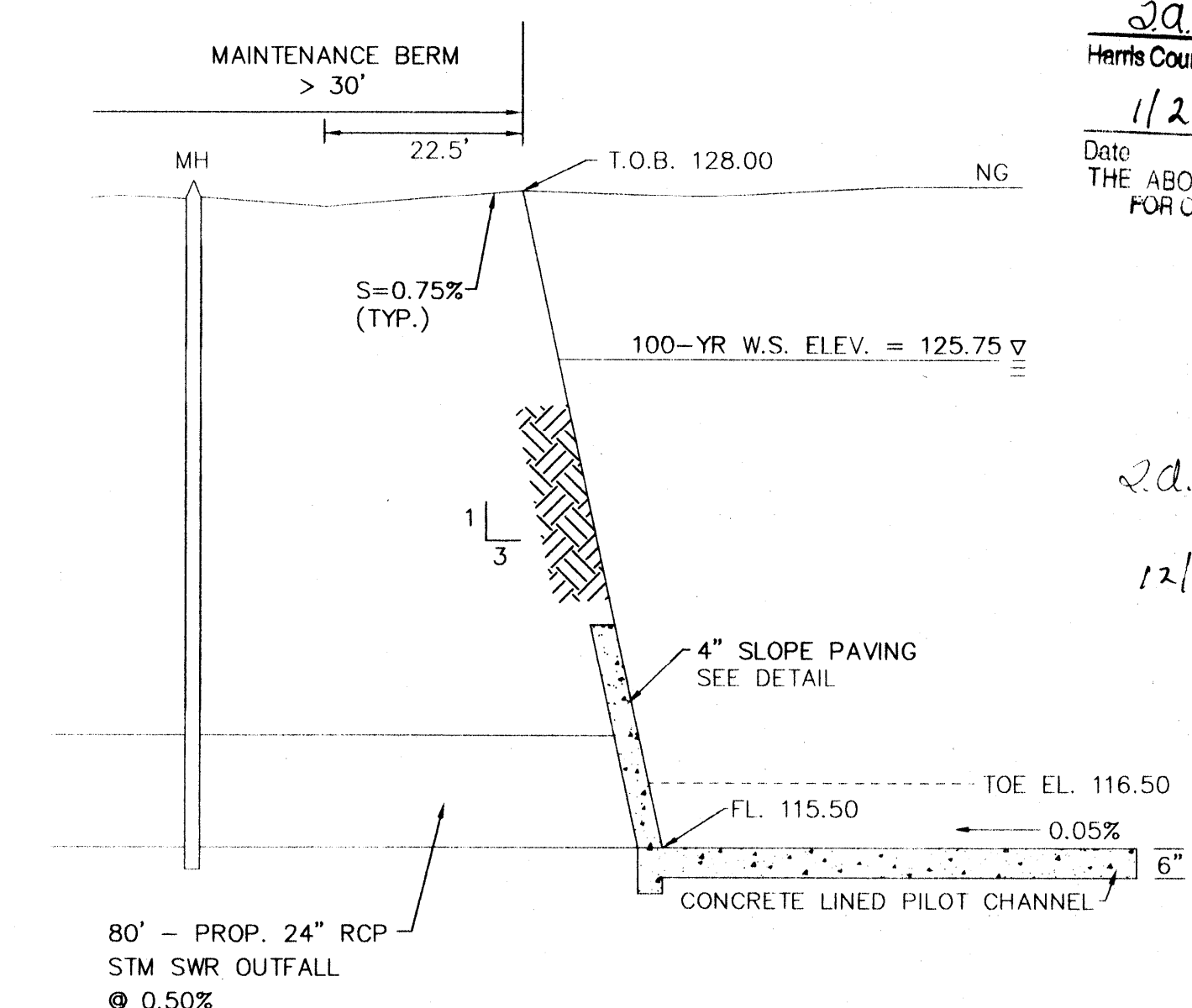

SECTION E-E
N.T.S.