

WATERLINE PROTECTION NOTE:
When sanitary sewer and waterline cross, both shall be constructed in strict accordance with City of Houston 'Infrastructure Design Manual' Table 7.4: Protection Requirements at Water Line - Sanitary Sewer Crossings. SEE GENERAL NOTES SHEET

BENCH MARK
BENCHMARK: NATIONAL GEODETIC SURVEY MARKER
Y1216, 1973 ADJ., ELEV = 125.994
Y1216, 1978 ADJ., ELEV = 125.406
Y1216, 1988 ADJ., ELEV = 123.94
ELEVATIONS ARE BASED ON 1973 ADJUSTMENT

FILL NOTE
Fill to be placed in maximum 8" lifts to 95% Standard Proctor Density ± 2% optimum moisture. Existing swales and ponds to shall be cleaned and mucked free from vegetation prior to placement of fill material.

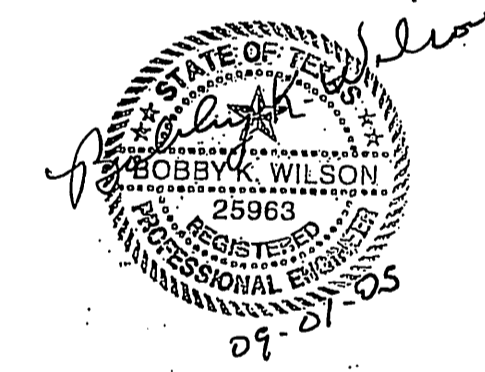
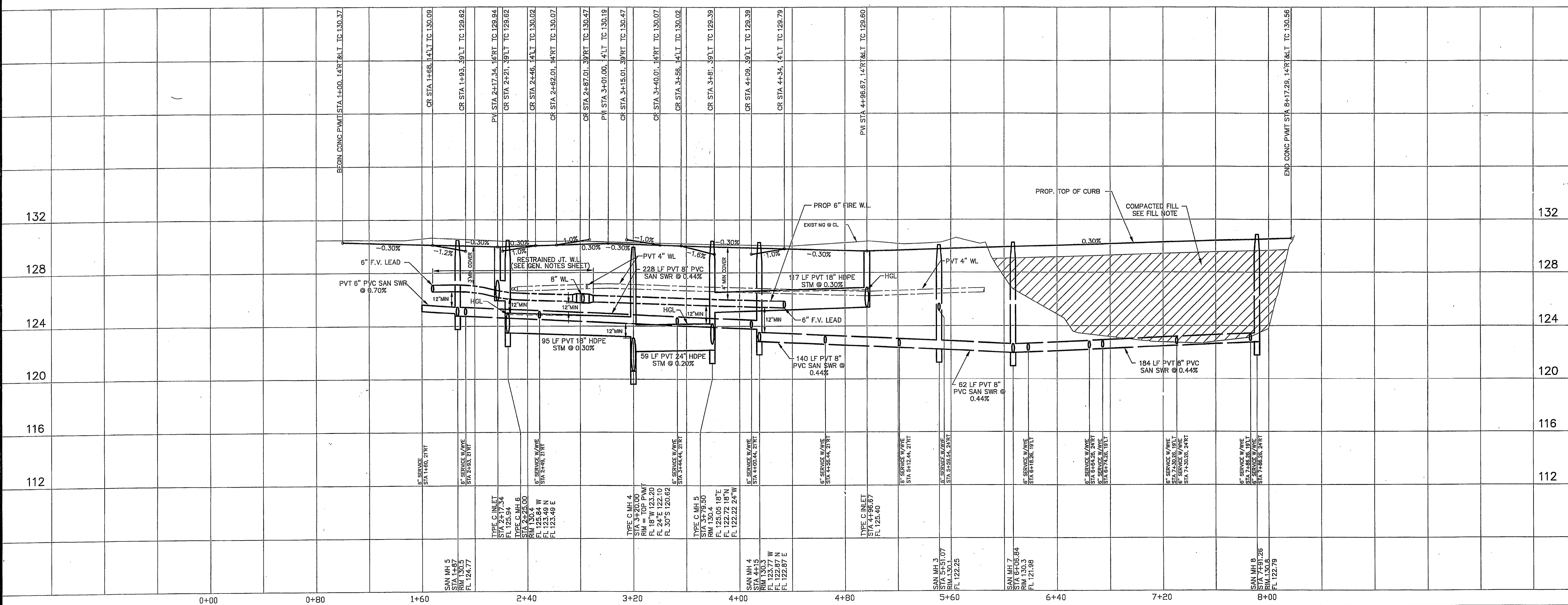

PROVIDENT CONSULTING, INC.
1405 ALLSTON ST.
HOUSTON, TEXAS 77008
(713)802-1019

PRIVATE UTILITY LINES SHOWN

CENTERPOINT ENERGY, ENTEX
SBC VALID FOR ONE YEAR
APPROVED ONLY FOR UNDERGROUND CONDUIT FACILITIES
CENTERPOINT ENERGY
APPROVED ONLY FOR CROSSING UNDERGROUND DUCTILES
UNLESS NOTED VALID AT TIME OF REVIEW ONLY.

VILLAS AT WILLOWBROOK
in
HARRIS COUNTY MUD 191
HARRIS COUNTY, TEXAS
PLAN & PROFILE
VILLA DE NORTE STREET
PLAN & PROFILE
VILLA ARBOR DRIVE

WATER	WASTEWATER	TRAFFIC
ST. & BRIDGE	STORMWATER	SWQ

FILE NO:
DRAWING SCALE:
1" = 40'
VERT: 4' HORZ: 40'
SHEET No: 9 OF 24

