

BENCHMARK: NATIONAL GEODETIC SURVEY MARKER
 Y1216, 1973 ADJ. ELEV = 125.994
 Y1216, 1978 ADJ. ELEV = 125.406
 Y1216, 1988 ADJ. ELEV = 123.94
 ELEVATIONS ARE BASED ON 1973 ADJUSTMENT

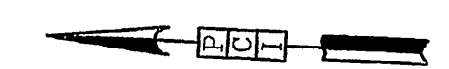

CHAMPIONS ARBOR
 FILM CODE NO. 448016

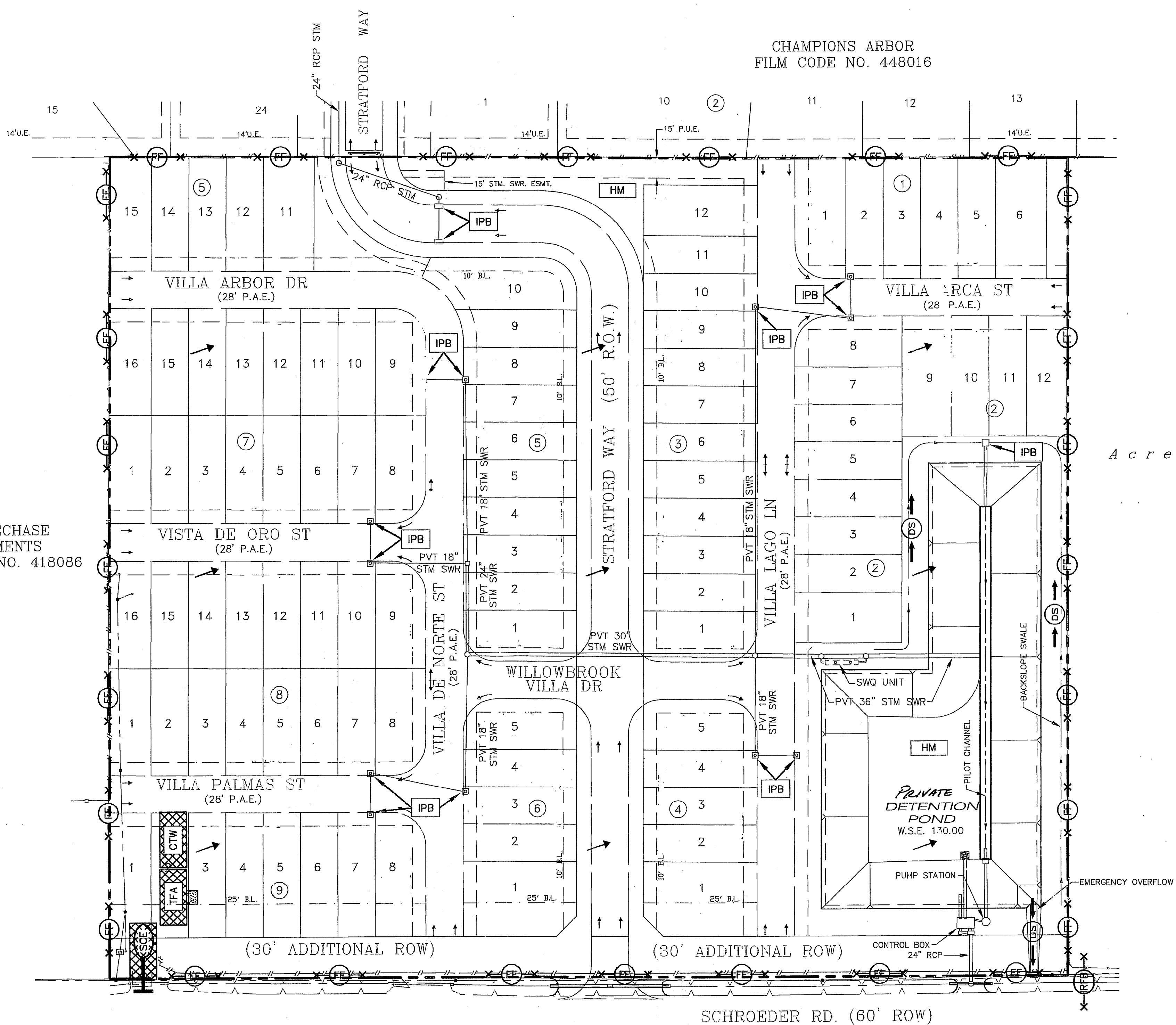

Privately owned utilities within private properties shall be reviewed and released by the County Engineer's Office.

LEGEND

- HYDROMULCH SEEDING
- STABILIZED CONSTRUCTION EXIT
- FILTER FABRIC FENCE
- REINFORCED FILTER FABRIC BARRIER
- INLET PROTECTION BARRIER
- DIVERSION SWALE
- CONCRETE TRUCK WASHOUT
- TEMPORARY FUELING AREA
- EXISTING SHEET FLOW

Acreeage

NOTE

Contractor to remove all temporary storm water pollution prevention measures upon completion of project.

STORM WATER POLLUTION PREVENTION NOTES

The contractor shall be responsible for implementing this Storm Water Pollution Prevention Plan prior to commencing construction activities.

The contractor shall complete and sign the T.C.E.Q. "Construction Site Notice" (Attachment # 2 of TPDES General Permit TXR 150000).

The contractor shall post a signed copy of the "Construction Site Notice" where it is readily available for viewing by the General Public and Local, State and Federal authorities prior to commencing construction activities and shall maintain this notice until completion of the work.

The contractor shall provide a copy of the signed "Construction Site Notice" to the operator of any municipal storm sewer systems receiving storm water discharge from the site at least two days prior to commencement of construction activities.

STEEPLECHASE APARTMENTS
 FILM CODE NO. 418086

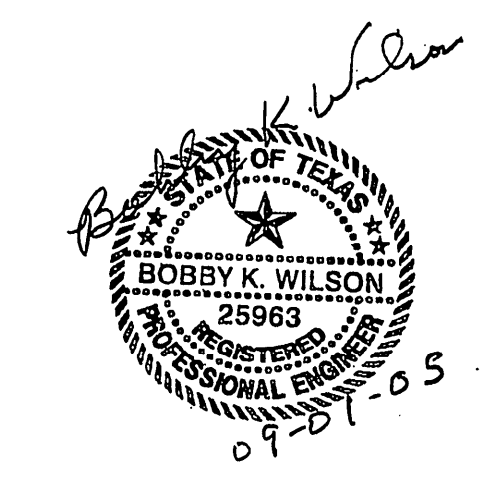

PROVIDENT CONSULTING, INC.
 1405 ALLSTON ST.
 HOUSTON, TEXAS 77008
 (713)802-1019

PRIVATE UTILITY LINES SHOWN

CENTERPOINT ENERGY, ENTEX
 SBC VALID FOR ONE YEAR
 APPROVED ONLY FOR CROSSING UNDERGROUND CONDUIT FACILITIES
 CENTERPOINT ENERGY
 APPROVED ONLY FOR CROSSING UNDERGROUND FACILITIES
 UNLESS NOTED VALID AT TIME OF REVIEW ONLY.

VILLAS AT WILLOWBROOK
 HARRIS COUNTY MUD 191
 HARRIS COUNTY, TEXAS
STORM WATER POLLUTION PREVENTION PLAN

WATER	WASTEWATER	TRAFFIC
ST. & BRIDGE	STORMWATER	SWG
FILE NO:		
DRAWING SCALE:	1" = 50'	
VERT:	HORZ:	
SHEET No: 5 OF 24		