

BENCH MARK

BENCHMARK: NATIONAL GEODETIC SURVEY MARKER
 Y1216, 1973 ADJ., ELEV = 125.994
 Y1216, 1978 ADJ., ELEV = 125.406
 Y1216, 1988 ADJ., ELEV = 123.94
 ELEVATIONS ARE BASED ON 1973 ADJUSTMENT

FLOOD PLAIN STATEMENT:
 No portion of this tract lies within a "100 year flood hazard area" as designated on The National Flood Insurance Program - Flood Insurance Rate Map issued by the Federal Emergency Management Agency under Community Panel Number 480287 0435 J for Harris County, Texas dated November 6, 1996.



CHAMPIONS ARBOR
 FILM CODE NO. 448016

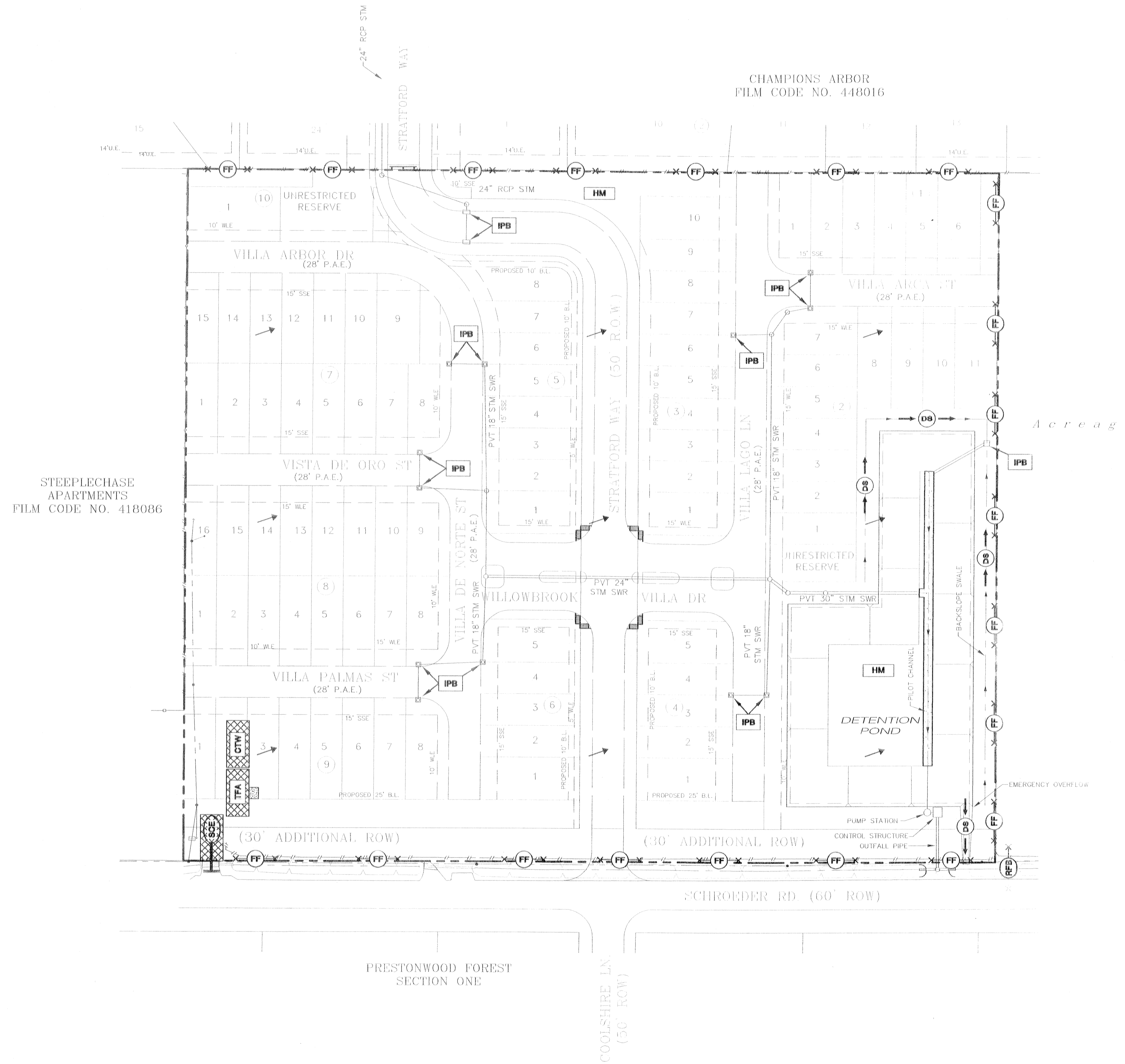

LEGEND

- HYDROMULCH SEEDING
- STABILIZED CONSTRUCTION EXIT
- FILTER FABRIC FENCE
- REINFORCED FILTER FABRIC BARRIER
- INLET PROTECTION BARRIER
- DIVERSION SWALE
- CONCRETE TRUCK WASHOUT
- TEMPORARY FUELING AREA
- EXISTING SHEET FLOW

NOTE

ONLY FILTER FABRIC FENCE WILL BE REQUIRED FOR THIS (CLEANING, GRUBBING, AND EXCAVATION) CONTRACT.

STORM WATER POLLUTION PREVENTION NOTES

The contractor shall be responsible for implementing this Storm Water Pollution Prevention Plan prior to commencing construction activities.

The contractor shall complete and sign the T.C.E.Q. "Construction Site Notice" (Attachment # 2 of TPDES General Permit TXR 150000).

The contractor shall post a signed copy of the "Construction Site Notice" where it is readily available for viewing by the General Public and Local, State and Federal authorities prior to commencing construction activities and shall maintain this notice until completion of the work.

The contractor shall provide a copy of the signed "Construction Site Notice" to the operator of any municipal storm sewer systems receiving storm water discharge from the site at least two days prior to commencement of construction activities.

PRIVATE UTILITY LINES SHOWN

CENTERPOINT ENERGY, ENTX

SBC VALID FOR ONE YEAR
 APPROVED ONLY FOR UNDERGROUND CONDUIT FACILITIES

CENTERPOINT ENERGY
 APPROVED ONLY FOR CROSSING UNDERGROUND FACILITIES
 SPACES NOTED VALID AT TIME OF REVIEW ONLY

VILLAS AT WILLOWBROOK
 HARRIS COUNTY MUD 191
 HARRIS COUNTY, TEXAS

STORM WATER
 POLLUTION
 PREVENTION PLAN

WATER	WASTEWATER	TRAFFIC
ST. & BRIDGE	STORMWATER	SWQ

FILE NO.
 DRAWING SCALE:
 1" = 50'
 VERT: HORZ:
 SHEET No: 3 OF 3

STEEPLECHASE APARTMENTS
 FILM CODE NO. 418086

PROVIDENT CONSULTING, INC.
 1200 WEST 11TH ST.
 HOUSTON, TEXAS 77008
 (713)802-1019
PC
 PROVIDENT CONSULTING, INC.