

**WARNING**  
OVERHEAD AND UNDERGROUND UTILITIES MAY EXIST IN THE VICINITY OF THIS PROJECT. LOCATIONS SHOWN FOR EXISTING UTILITIES ARE APPROXIMATE AND OTHER UTILITIES MAY EXIST IN THE VICINITY OF THE PROJECT WHICH ARE NOT SHOWN ON THE PLANS. IT IS THE RESPONSIBILITY OF THE CONTRACTOR TO LOCATE EXACT ALL EXISTING UTILITIES IN THE VICINITY OF THE PROJECT PRIOR TO BEGINNING CONSTRUCTION. IF ANY DISCREPANCY EXISTS, NOTIFY ENGINEER.

**ONE-CALL NOTIFICATION SYSTEM**  
**CALL BEFORE YOU DIG**  
48 HOURS NOTICE BEFORE YOU DIG, DRILL, OR BLAST - STOP CALL TEXAS811 (DIG TRSS)(1-800-844-8377) OR LONE STAR NOTIFICATION CENTER (1-800-669-8344)

**STEEL CASING NOTE:**  
STEEL CASING SHALL BE AT LEAST TWO NOMINAL SIZES LARGER THAN THE CARRIER PIPE PER CITY OF HOUSTON DEPARTMENT OF PUBLIC WORKS AND ENGINEERING DESIGN MANUAL SECTION 7.03.1.

NO. REVISIONS	DATE
1	AS-BUILT CORRECTIONS
2	12-5-16

TO ARRANGE FOR LINES TO BE TURNED OFF OR MOVED, CALL CENTERPOINT ENERGY AT 713-207-2222.

**NOTICE:**  
FOR YOUR SAFETY, YOU ARE REQUIRED BY TEXAS LAW TO CALL 811 AT LEAST 48 HOURS BEFORE YOU DIG SO THAT UNDERGROUND LINE CAN BE MARKED. THIS VERIFICATION DOES NOT FULLY OBLIGATE YOUR OBLIGATION TO CALL 811.

**PRIVATE UTILITY LINES SHOWN**  
Date: 1-27-16  
AT&T TEXAS/SWBT FACILITIES  
Approved for AT&T/SWBT underground conduit facilities ONLY  
SIGNATURE VALID FOR ONE YEAR.

Date: 1/27/16  
CENTERPOINT ENERGY/NATURAL GAS FACILITIES VERIFICATION ONLY.  
(THIS SIGNATURE VERIFIES THAT YOU HAVE SHOWN ORP NATURAL GAS LINES CORRECTLY. NOT TO BE USED FOR CONFLICT VERIFICATION.) (GAS SERVICE LINES ARE NOT SHOWN.) SIGNATURE VALID FOR SIX MONTHS.

Date: 1/27/16  
CENTERPOINT ENERGY/UNDERGROUND ELECTRIC FACILITIES VERIFICATION ONLY. (THIS SIGNATURE VERIFIES EXISTING UNDERGROUND FACILITIES - NOT TO BE USED FOR CONFLICT VERIFICATION.) SIGNATURE VALID FOR SIX MONTHS.

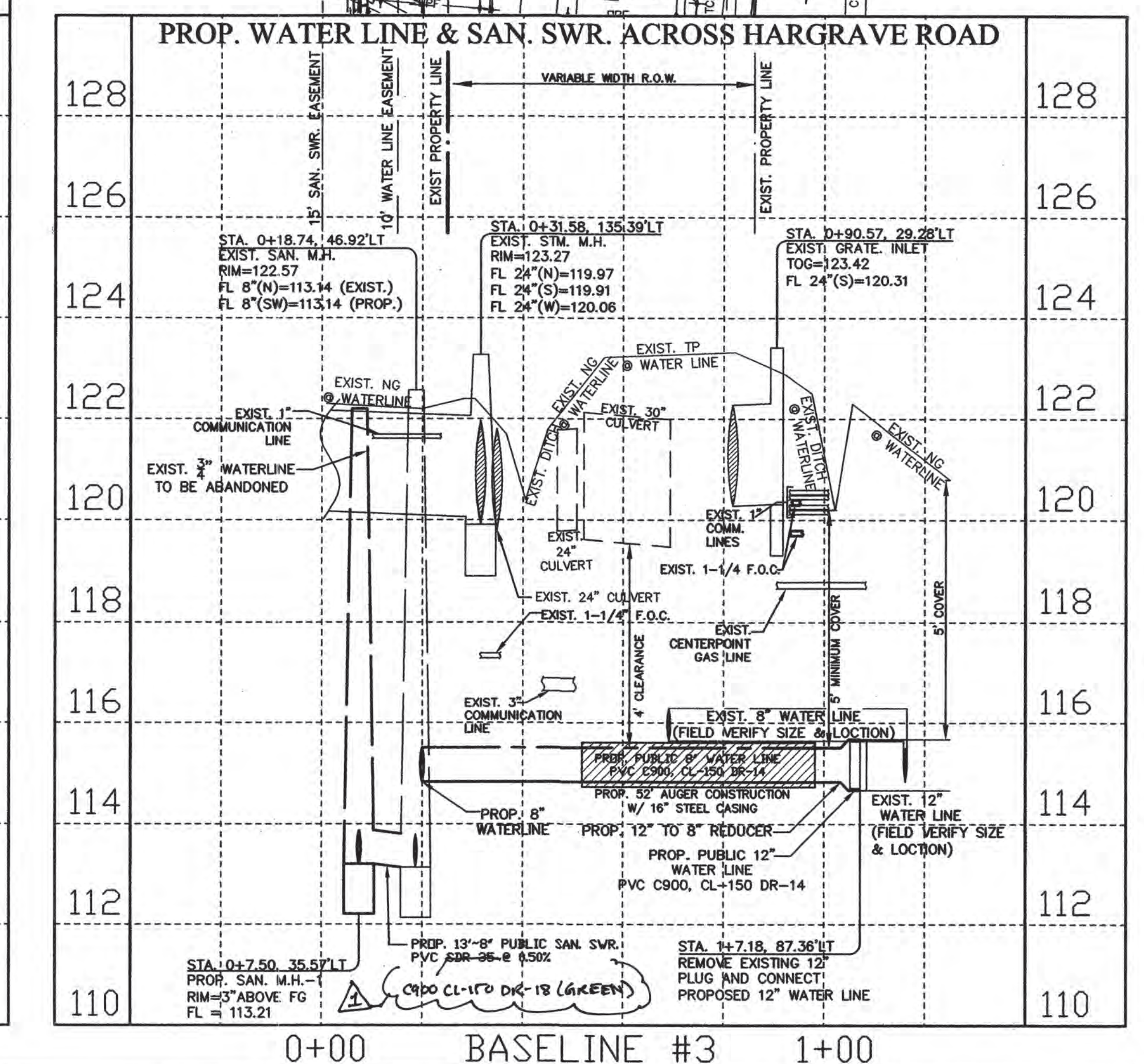
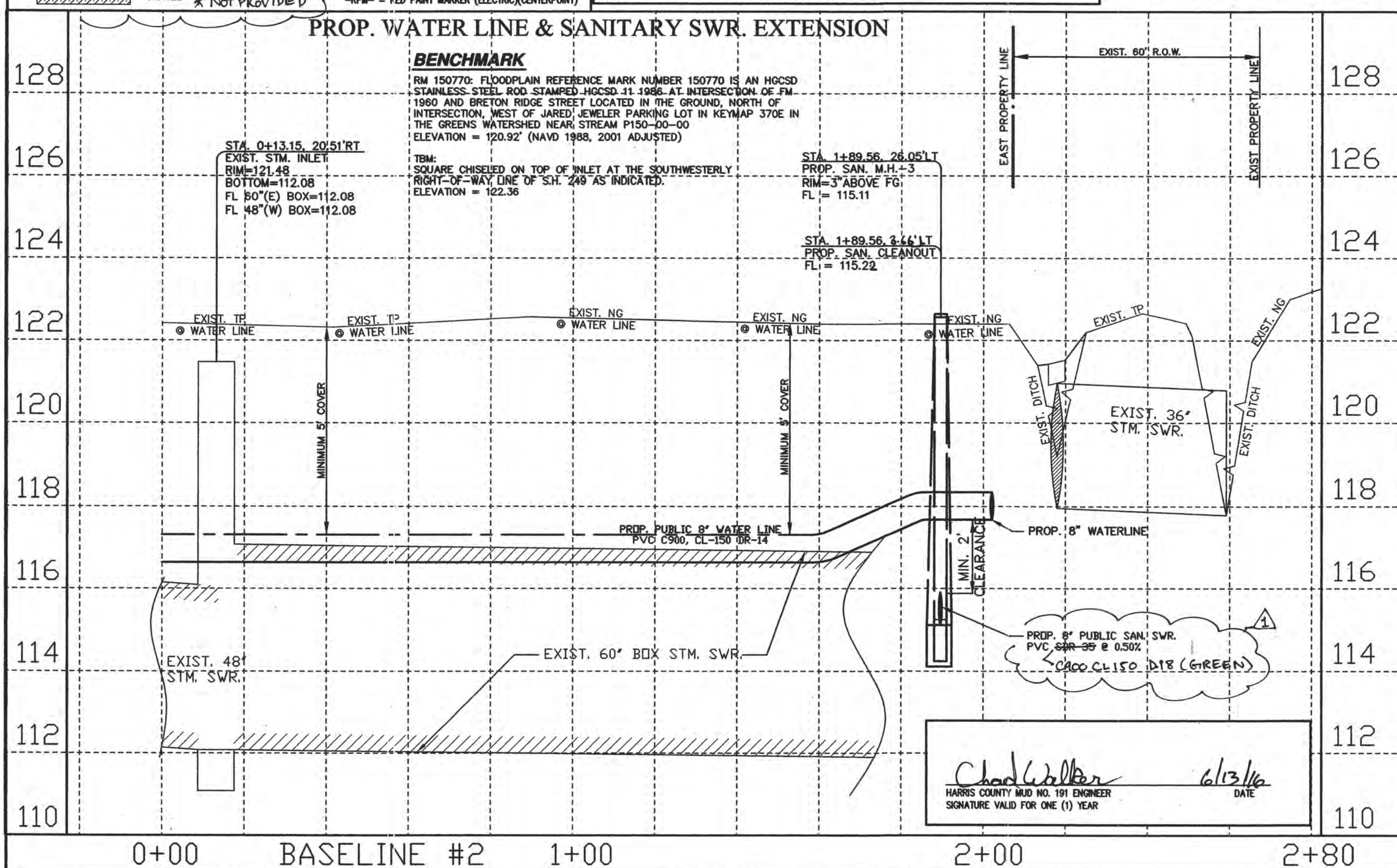

**HEIGHTS ENGINEERING LLC**  
CONSULTING ENGINEERS  
7324 SOUTHWEST Fwy SUITE 995 HOUSTON, TX 77074  
PHONE: (713) 333-0363 FAX: (281) 274-9153  
www.HEIGHTSENGINEERING.COM  
TEXAS REG. NO. 1-0233

**PROP. 8" WATER LINE & 8" SANITARY SEWER**  
ALONG HARGRAVE ROAD  
TO SERVICE HARRIS COUNTY MUD #191  
BASELINE #2 STATION 0+00 TO END  
HARGRAVE-BASELINE #3 STATION 0+00 TO END  
HEIGHTS PROJ. NO. 14-190 DRAWING NO. 14190402  
NOTE: CITY SIGNATURES VALID FOR ONE YEAR ONLY AFTER DATE OF SIGNATURES

**CITY OF HOUSTON**  
DEPARTMENT OF PUBLIC WORKS AND ENGINEERING

WATER	TRAFFIC & TRANSPORTATION
WASTEWATER	STORM WATER QUALITY
STORM	FACILITIES
STREET & BRIDGE	

FILE NO.:  
DRAWING SCALE  
HORIZ: 1" = 20'  
VERT: 1" = 2'  
DRAWN BY: SA  
CHECKED BY: RM

CITY DWG NO.:  
55439  
CITY DRAWING NUMBER

CON LOG# 15-1136  
SHEET NO: 7 OF 11  
**AS-BUILT**